

Hours of Operation

Guest Services Desk and EPIC Center

Monday - Thursday: 7 a.m. – 11 p.m.

Saturday: 9 a.m. – 11 p.m.

Sunday: 9 a.m. – 9 p.m.

First Floor

- **Assembly Room (1075)**
- **Dunkin' Donuts**
Monday – Friday: 7:30 a.m. – 5:30 p.m.
Saturday: 9 a.m. – 4 p.m.
Sunday: 10 a.m. – 7 p.m.
- **Group Study Rooms A & B (1088 - 1089)**
- **Information & Guest Services (1001)**
- **Learning Centers (1100-1167)**
 - Communication Center (1155)**
 - Digital Communication Consulting (1160)**
 - English Language Learners Services (1152)**
 - Peer Assisted Study Sessions (1119)**
 - Science & Math Learning Center (1100)**
 - University Writing Center (1160)**
- Monday – Thursday: 10 a.m. – 8 p.m.
Friday: 8 a.m. – 2 p.m.
Sunday: 5 p.m. – 8 p.m.
- **Office of Disability Services (1202)**
 - Learning Strategies Instruction**
- Monday – Friday: 8 a.m. – 5 p.m.
- **SafeRides (1083)**
- **Student Success Center Operations (1200–1201)**
- **Urgent Care (1400 – 1500)**
Monday, Wednesday, Friday: 8 a.m. – 4 p.m.
Tuesday, Thursday: 9 a.m. – 4 p.m.
- **University Health Center – The Well (1311 – 1331)**
 - Health Education, Prevention and Outreach**
 - LGBTQ & Ally Education Program (1313)**
- Monday, Wednesday, Friday: 8a.m.-5p.m.
Tuesday, Thursday: 9a.m.-5p.m.
- **Pharmacy (1300)**
Monday, Wednesday, Friday: 8 a.m. – 4:30 p.m.
Tuesday, Thursday: 9 a.m. – 4:30 p.m. (Closed 12 p.m. – 1 p.m.)

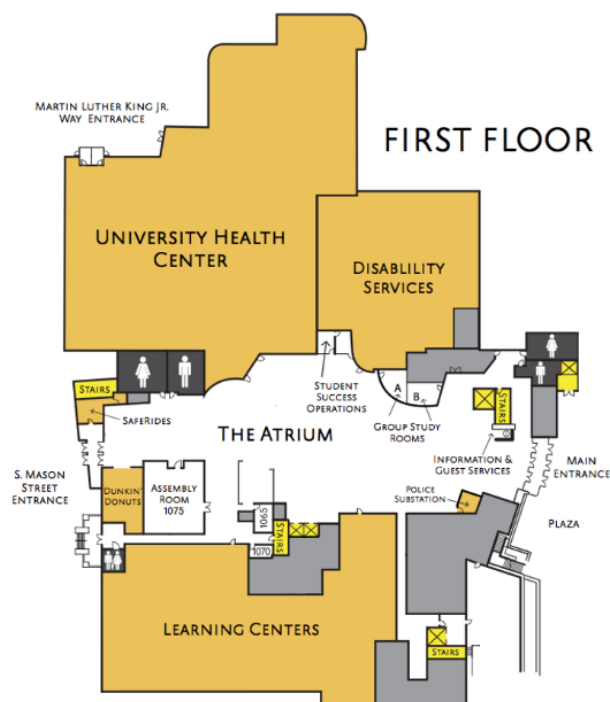

Second Floor

- **Bistro 1908**
Monday – Thursday: 11 a.m. – 8:30 p.m.
Friday: 11 a.m. – 3 p.m.
 - **Get Your Green On**
 - **Italian Kitchen**
 - **Grillhouse**
 - **Gelato and Juice**
 - **Food Local**
- Monday – Thursday: 8 a.m. – 8:30 p.m.
Friday: 8 a.m. – 3 p.m.
- **Card Services (2300 - 2303)**
Monday- Friday: 8 a.m. – 5 p.m.
- **Centennial Scholars Program (2180 - 2184)**
Monday – Friday: 7:30 a.m. – 4:30 p.m.
- **Community Service-Learning (2100)**
Monday – Friday: 8 a.m. – 5 p.m.
- **Office of Student Accountability & Restorative Practices (2120 - 2150)**
Monday – Friday: 8 a.m. – 5 p.m.
(Closed for lunch: 12 p.m. – 1 p.m.)
- **Orientation (2200 - 2210)**
Monday – Friday: 8 a.m. – 5 p.m.
- **Peer Educator Activity Room (PEAR)**
Monday – Friday: 8a.m. – 5 p.m.
- **University Health Center (2400-2560)**
Monday, Wednesday, Friday: 8a.m.-5p.m.
Tuesday, Thursday: 9a.m.-5p.m. (Closed 12 p.m. – 12:45 p.m.)

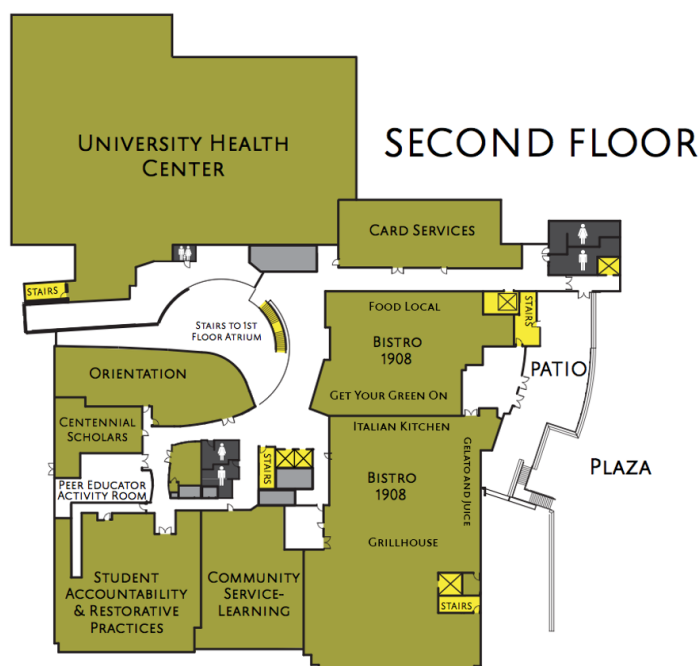

Third Floor

- **Administrative Offices (3010–3025)**
Monday – Friday: 8 a.m. – 5 p.m.
- **Career & Academic Planning (3210–3271)**
Monday – Friday: 8 a.m. – 5 p.m.
- **Conference Suite (3200 & 3202)**
- **Counseling Center (3100)**
Monday – Friday: 8 a.m. – 5 p.m.
- **Student Affairs Technical Services (3025)**
Monday – Friday: 8 a.m. – 5 p.m.

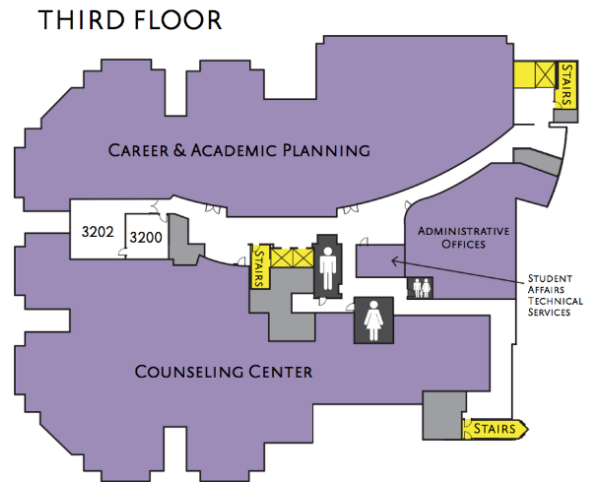

Fourth Floor

- **EPIC Center Classrooms (4030-4049)**
- **Epic Style Meeting Room (4049)**
- **Information Technology**
 - Help Desk (4010-4020/4050-4060)**
Monday – Thursday: 8 a.m. – 9 p.m.
Friday: 8 a.m. – 5 p.m.
Sunday: 3 p.m. – 9 p.m.
 - Test Scoring (4025)**
Monday – Thursday: 8 a.m. – 8 p.m.
Friday: 8 a.m. – 5 p.m.

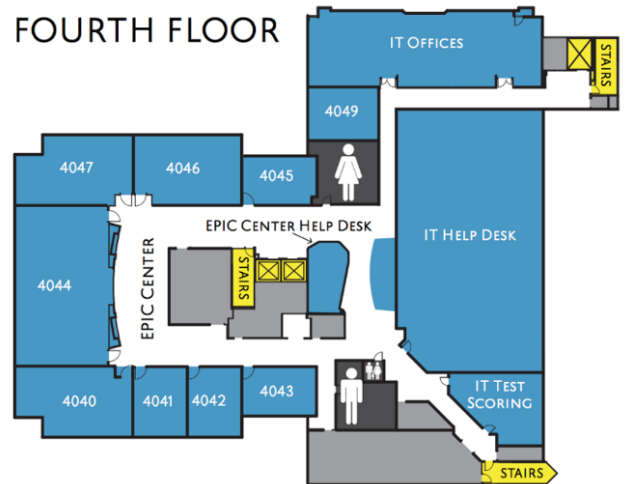

Fifth Floor

- **Financial Aid & Scholarships (5200–5400)**
Student Employment
Monday – Friday: 8 a.m. – 5 p.m.
- **Office of the Registrar (5300-5350)**
Monday – Friday: 8 a.m. – 5 p.m.
- **University Business Office (5100-5130)**
Monday – Friday 8 a.m. – 5 p.m.

