

WAMPLER HALL

GROUND FLOOR

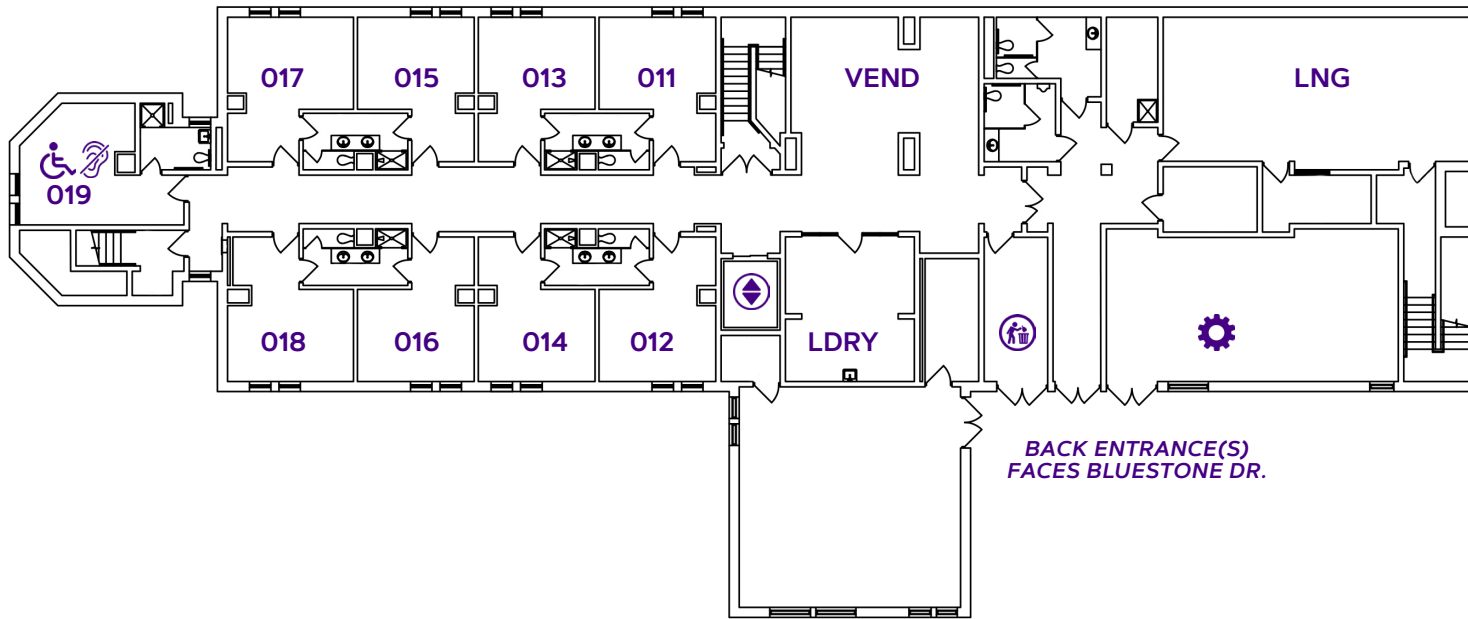

BACK ENTRANCE(S)
FACES BLUESTONE DR.

LEGEND:

- : Bathroom
- : Elevator
- : Mechanical Space/Misc. Use
- : Trash Room/Disposal Area
- : ADA Accessible Space
- : Hearing Equipment
- HD: Hall Director
- KTCH: Kitchen/Kitchenette
- LDRY: Laundry Room
- LNG: Lounge
Study Space/Room
Programming Space



Residence Life

WAMPLER HALL

FLOOR ONE

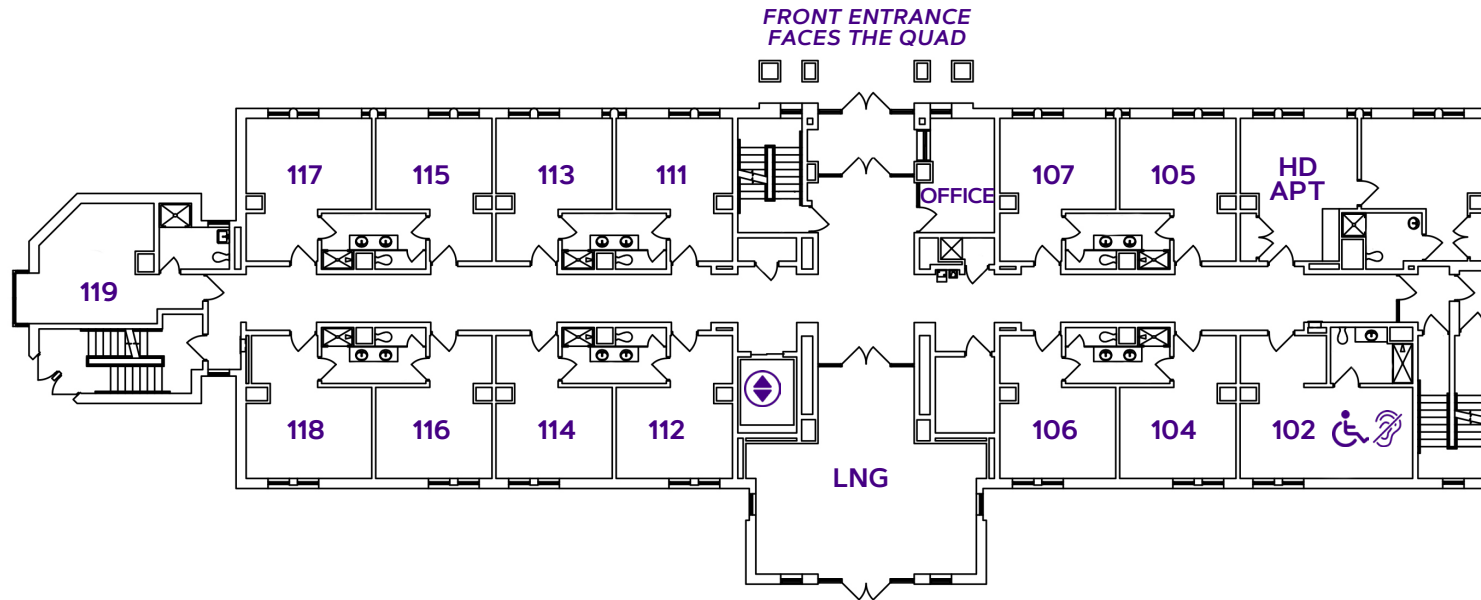

LEGEND:





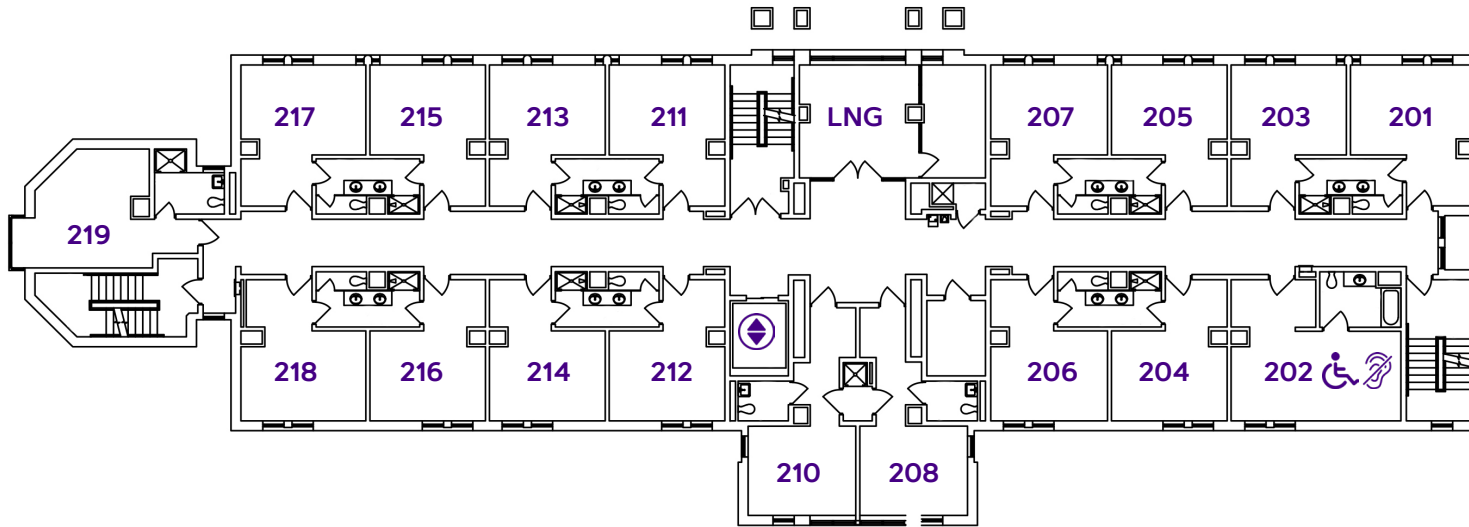

- : Bathroom
- : Elevator
- : Mechanical Space/Misc. Use
- : Trash Room/Disposal Area
- : ADA Accessible Space
- : Hearing Equipment
- HD: Hall Director
- KTCH: Kitchen/Kitchenette
- LDRY: Laundry Room
- LNG: Lounge
Study Space/Room
Programming Space

WAMPLER HALL

FLOOR TWO



LEGEND:





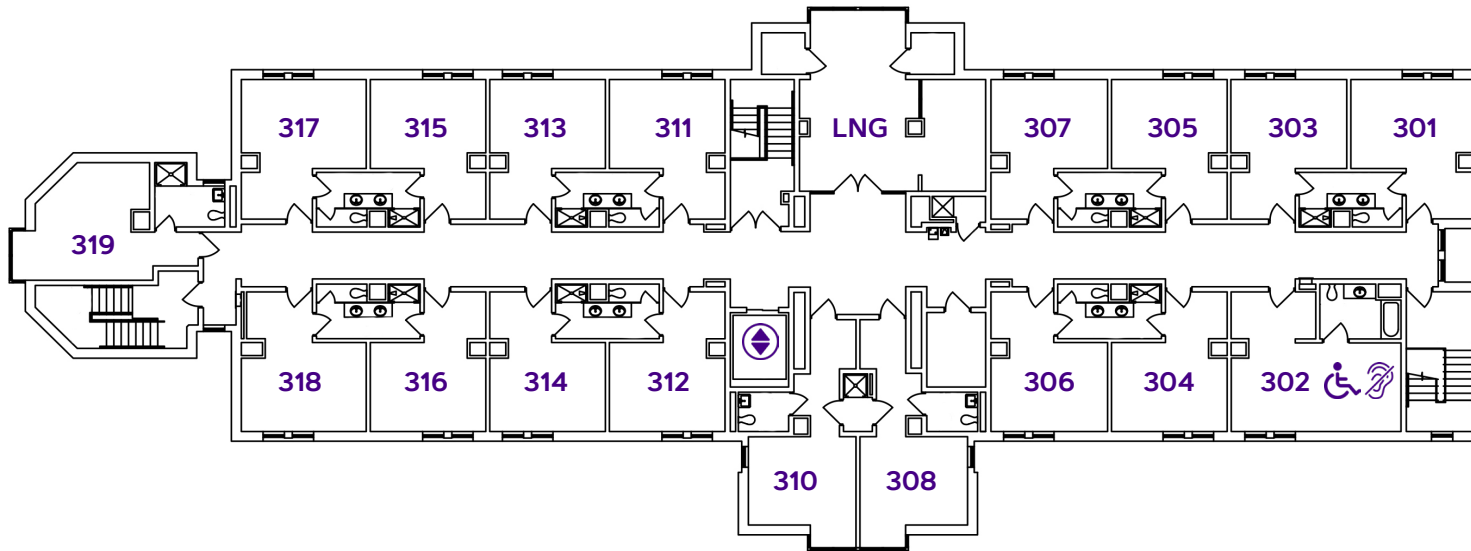

-  :Bathroom
-  :Elevator
-  :Mechanical Space/Misc. Use
-  :Trash Room/Disposal Area
-  :ADA Accessible Space
-  :Hearing Equipment
- HD: Hall Director
- KTCH: Kitchen/Kitchenette
- LDRY: Laundry Room
- LNG: Lounge
Study Space/Room
Programming Space

WAMPLER HALL

FLOOR THREE



LEGEND:





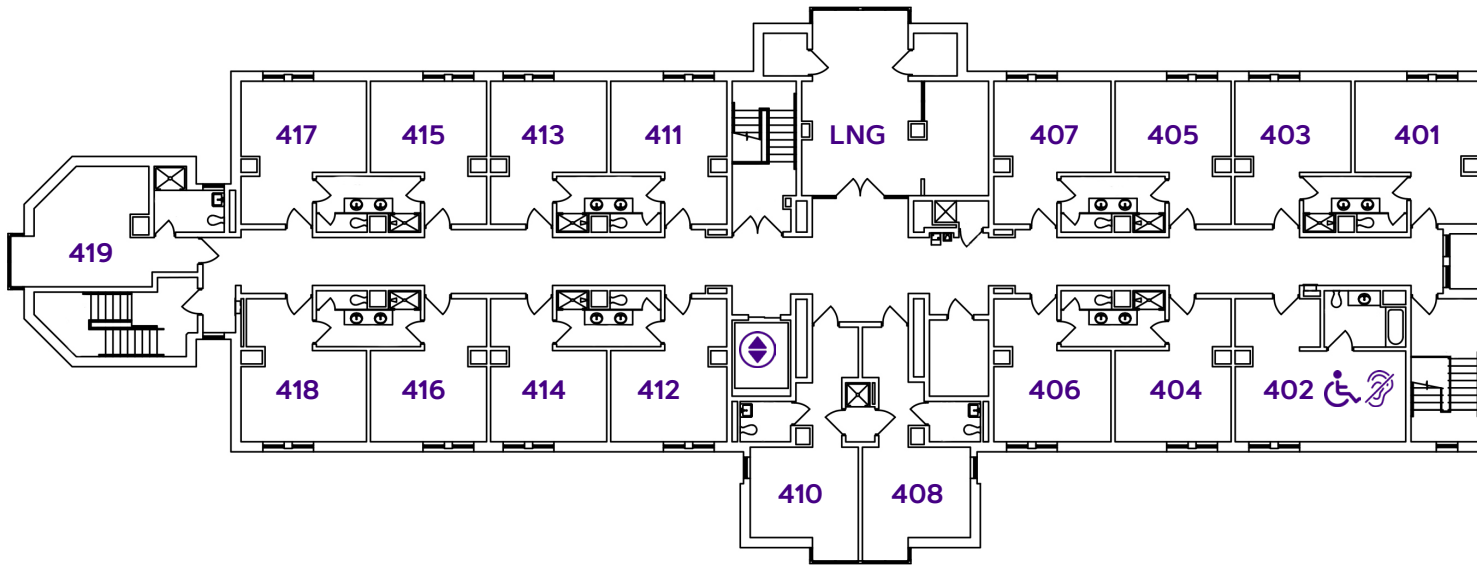

-  :Bathroom
-  :Elevator
-  :Mechanical Space/Misc. Use
-  :Trash Room/Disposal Area
-  :ADA Accessible Space
-  :Hearing Equipment
- HD: Hall Director
- KTCH: Kitchen/Kitchenette
- LDRY: Laundry Room
- LNG: Lounge
Study Space/Room
Programming Space

WAMPLER HALL

FLOOR FOUR



LEGEND:

-  : Bathroom
-  : Elevator
-  : Mechanical Space/Misc. Use
-  : Trash Room/Disposal Area
-  : ADA Accessible Space
-  : Hearing Equipment
- HD:** Hall Director
- KTCH:** Kitchen/Kitchenette
- LDRY:** Laundry Room
- LNG:** Lounge
Study Space/Room
Programming Space

WAMPLER HALL

ACCESSIBLE DESCRIPTION OF FLOOR PLAN

COMPLETED: 1994

CAPACITY: 153 residents

This is a rectangular building with four floors and a basement. The basement has one entrance on the back side of the building facing Converse. Next to this entrance is the trash room. You enter into a hallway. At the end of the hallway, the lounge is to the right. In the lounge, in the back right corner, is a stairwell. There are two individual public bathrooms in front of you; one directly in front, and the other to the left. Going left from the hallway leads you to the vending area and stairwell on the right and the laundry room and elevator on the left. The rest of the hallway is bedrooms with a stairwell at the end.

The first floor has two entrances. The main entrance is on the front and faces the quad and has stairs. The second entrance is on the side of the building facing Harper-Allen Lee. When you enter here, a stairwell is on your left. The rest of the hall is bedrooms and leads to the lobby. Once in the lobby, a lounge area and the elevator are on your left, and the hall office, main entrance, and a stairwell are on your right. In the back of the lounge there is a door that leads to an outdoor balcony; students will need their Jaccard to re-enter the lounge from the balcony. In front of you is another hallway of bedrooms with a stairwell at the end.

The second, third, and fourth floors are like the first without the lobby. There are hallways of bedrooms with stairwells at both ends and one in the middle. Also in the middle is a lounge with a study area, except the fourth floor has a kitchen instead of a study room. The stairwell here is next to the lounge, and the elevator is across from the stairwell.