

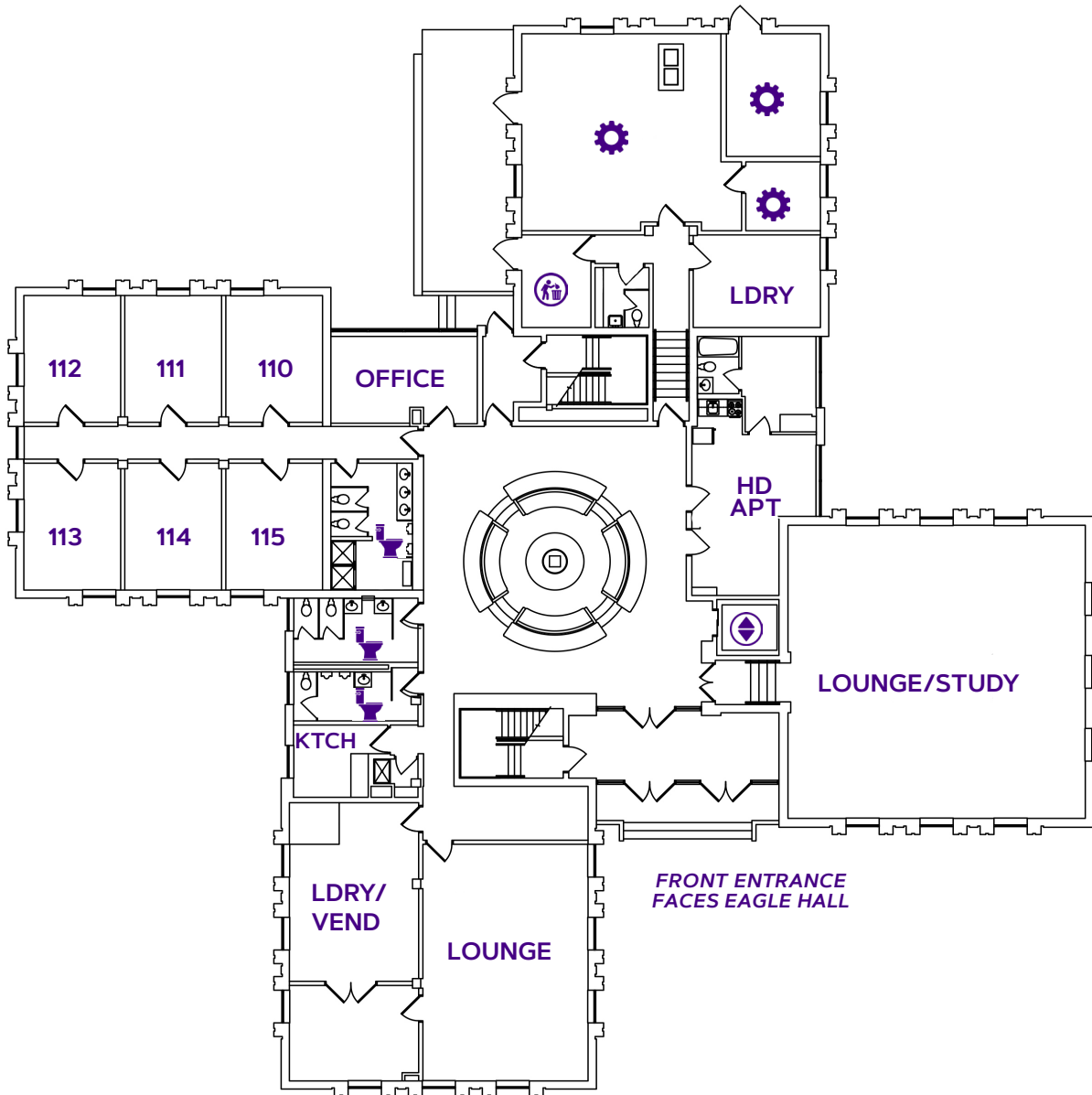





SHORTS HALL

FLOOR ONE



LEGEND:





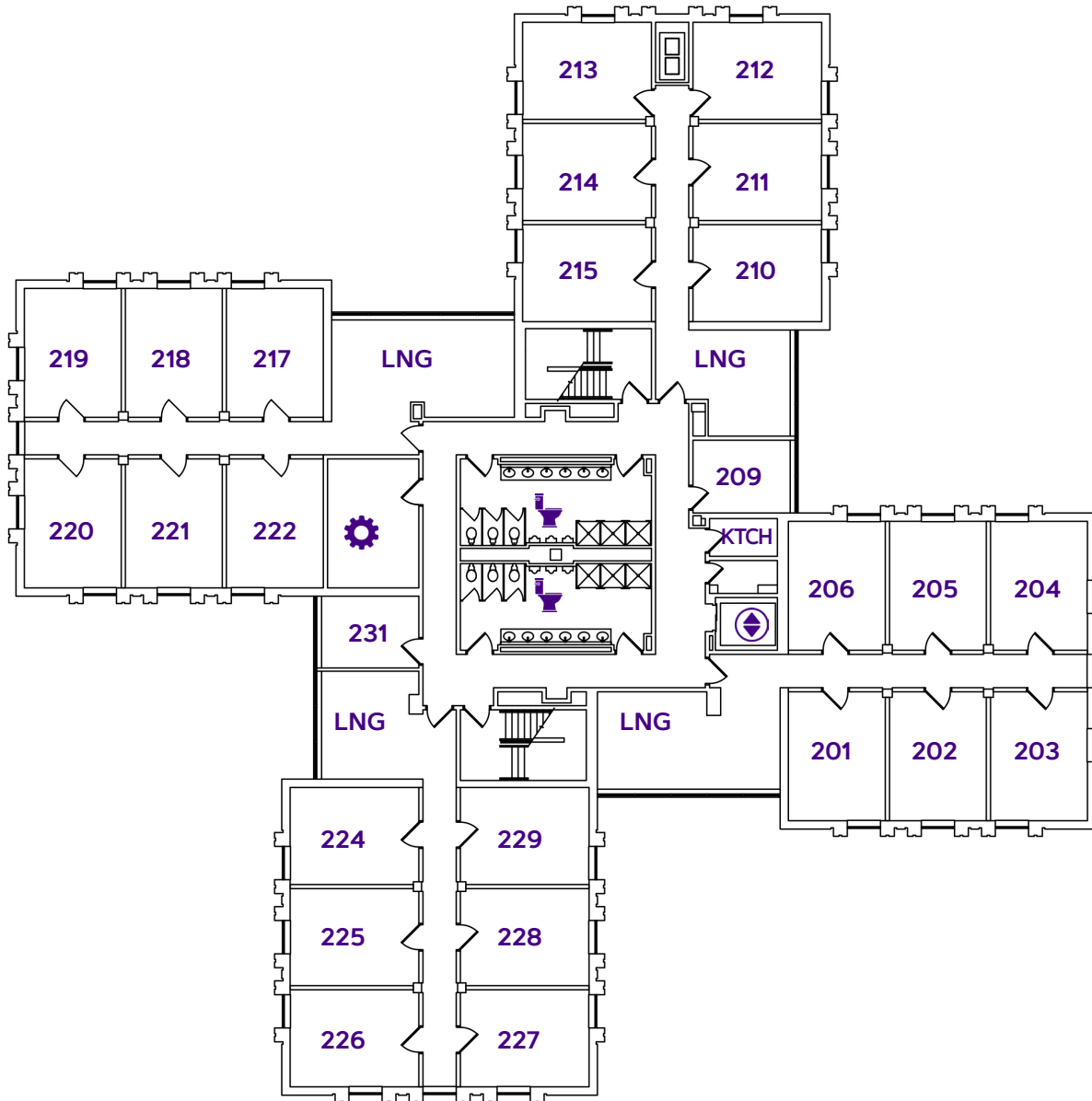

-  :Bathroom
-  :Elevator
-  :Mechanical Space/Misc. Use
-  :Trash Room/Disposal Area
-  :ADA Accessible Space
-  :Hearing Equipment
- HD: Hall Director
- KTCH: Kitchen/Kitchenette
- LDRY: Laundry Room
- LNG: Lounge
Study Space/Room
Programming Space

SHORTS HALL

FLOOR TWO



LEGEND:

-  : Bathroom
-  : Elevator
-  : Mechanical Space/Misc. Use
-  : Trash Room/Disposal Area
-  : ADA Accessible Space
-  : Hearing Equipment
- HD:** Hall Director
- KTCH:** Kitchen/Kitchenette
- LDRY:** Laundry Room
- LNG:** Lounge
Study Space/Room
Programming Space

SHORTS HALL

FLOOR THREE

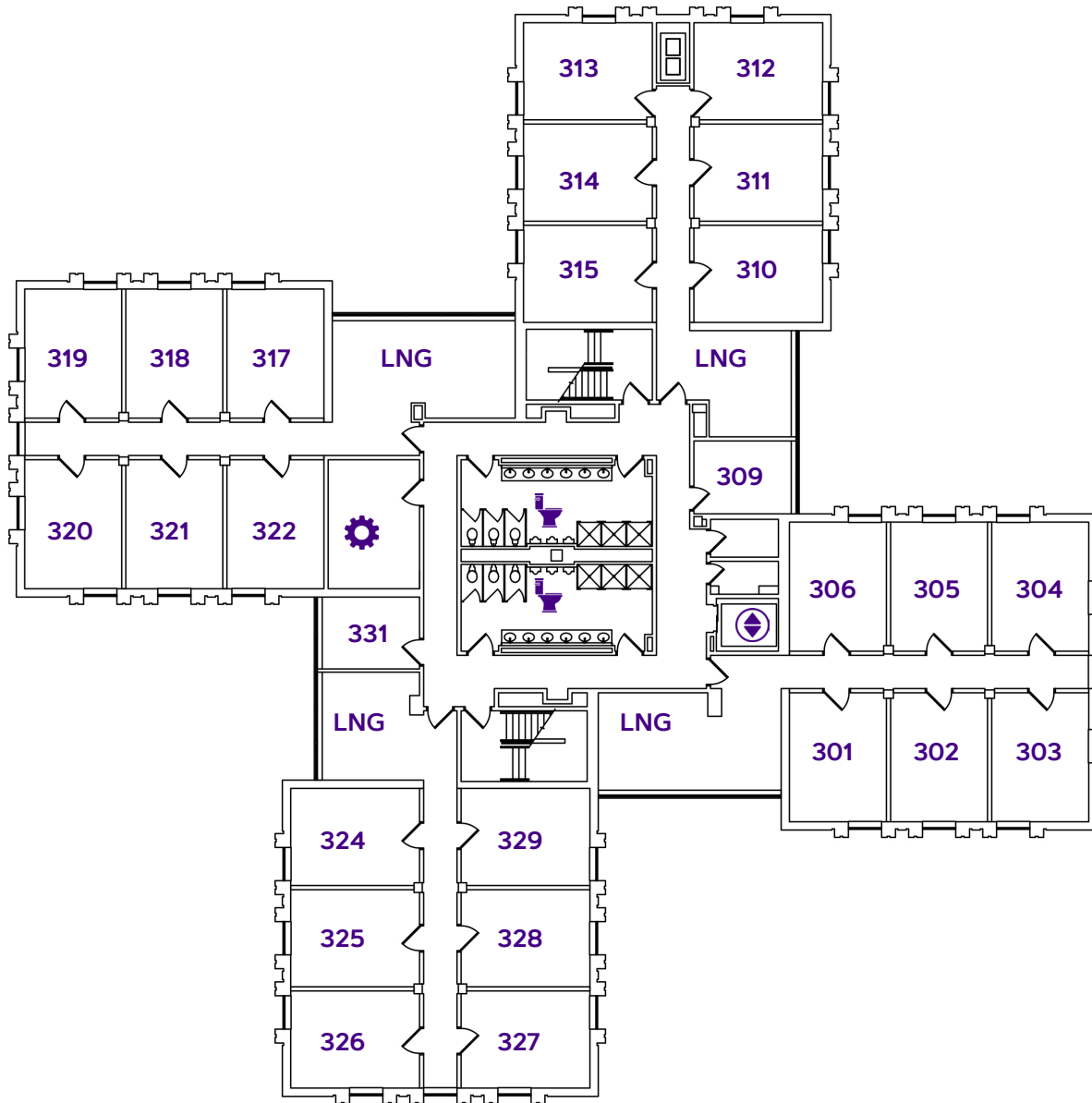

LEGEND:

- : Bathroom
- : Elevator
- : Mechanical Space/Misc. Use
- : Trash Room/Disposal Area
- : ADA Accessible Space
- : Hearing Equipment
- HD:** Hall Director
- KTCH:** Kitchen/Kitchenette
- LDRY:** Laundry Room
- LNG:** Lounge
Study Space/Room
Programming Space

SHORTS HALL

FLOOR FOUR

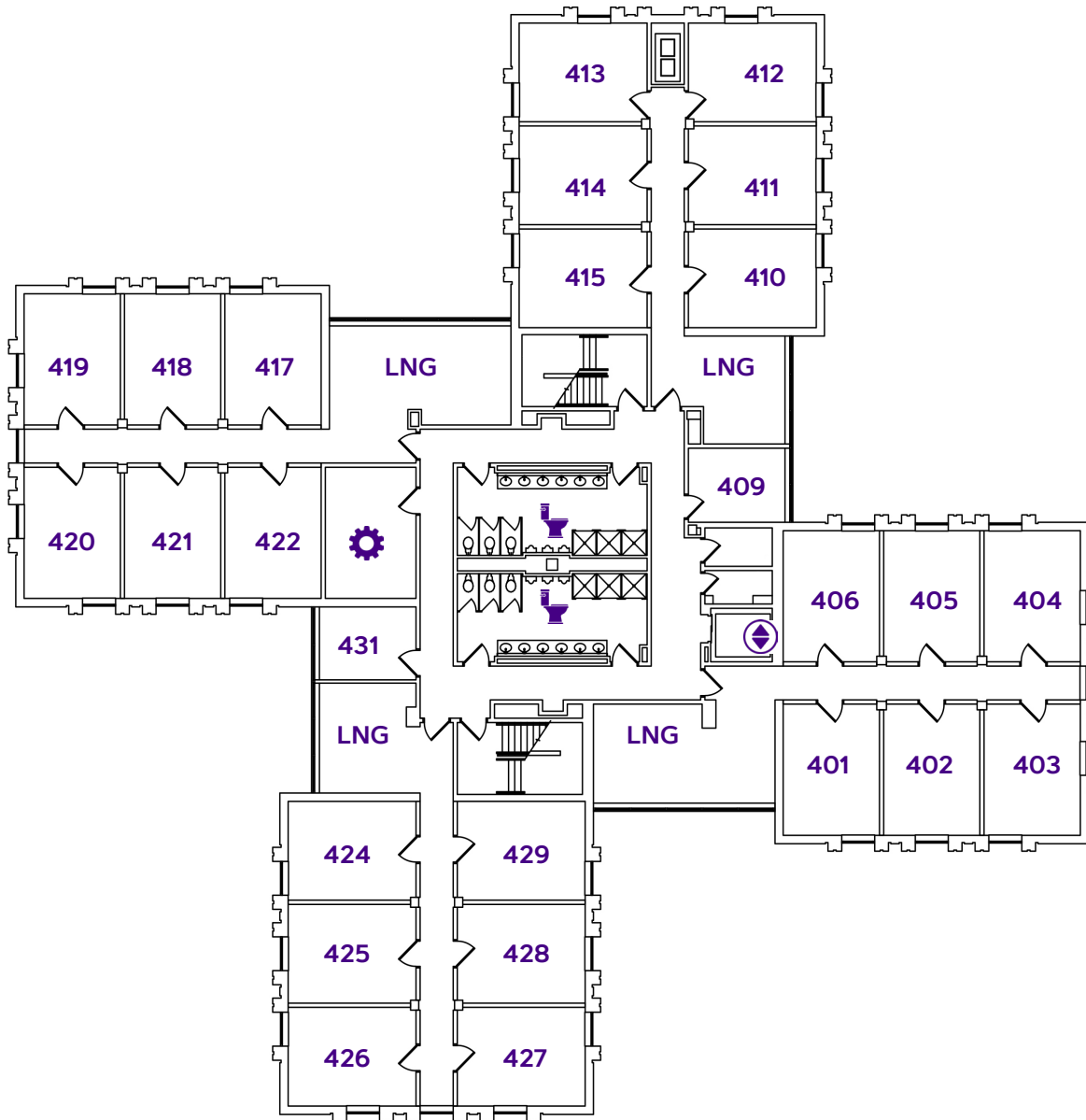

LEGEND:





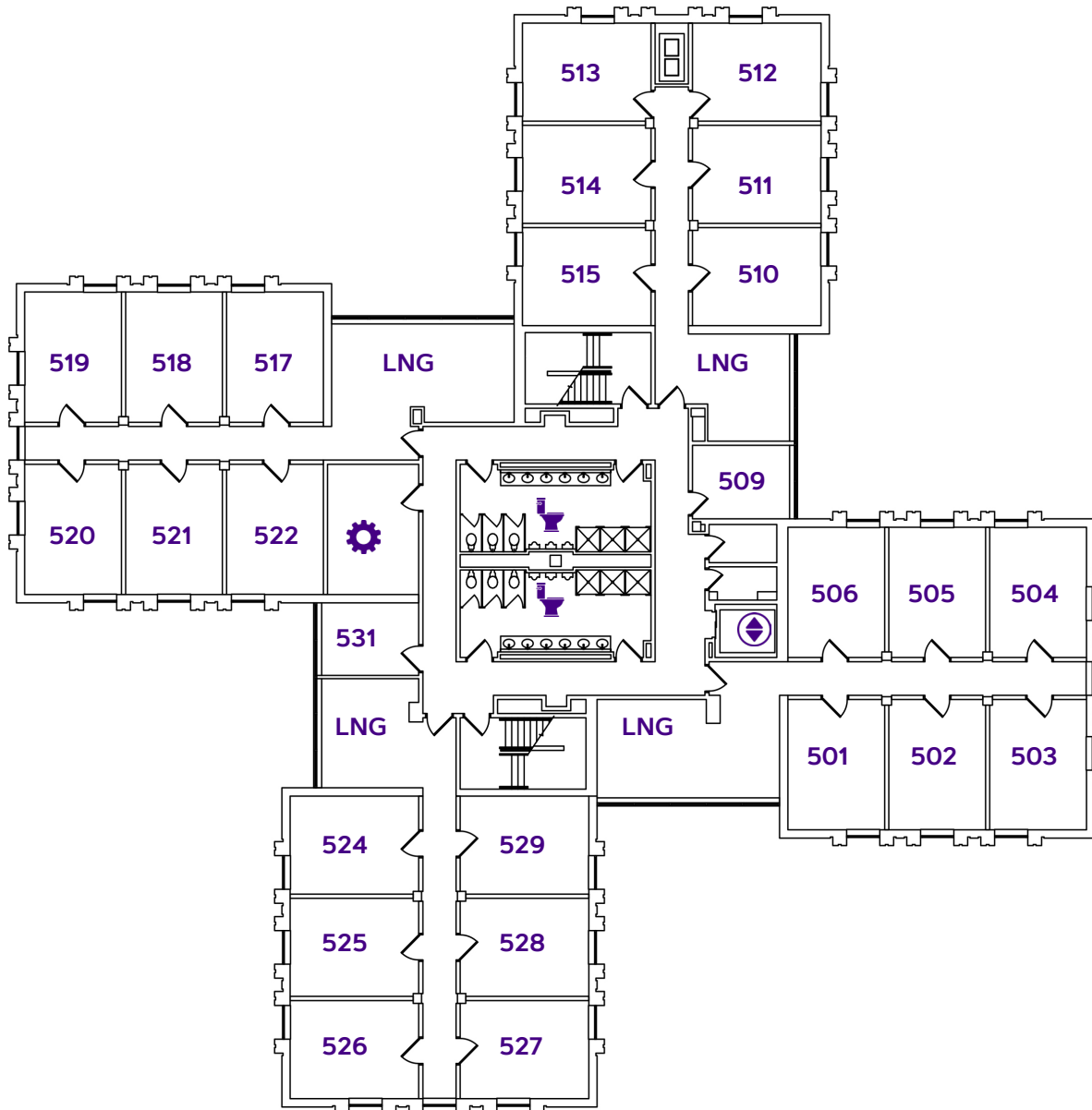

- : Bathroom
- : Elevator
- : Mechanical Space/Misc. Use
- : Trash Room/Disposal Area
- : ADA Accessible Space
- : Hearing Equipment
- HD: Hall Director
- KTCH: Kitchen/Kitchenette
- LDRY: Laundry Room
- LNG: Lounge
Study Space/Room
Programming Space

SHORTS HALL

FLOOR FIVE



LEGEND:

-  :Bathroom
-  :Elevator
-  :Mechanical Space/Misc. Use
-  :Trash Room/Disposal Area
-  :ADA Accessible Space
-  :Hearing Equipment
- HD:** Hall Director
- KTCH:** Kitchen/Kitchenette
- LD:** Laundry Room
- LNG:** Lounge
Study Space/Room
Programming Space

SHORTS HALL

ACCESSIBLE DESCRIPTION OF FLOOR PLAN

COMPLETED: 1968

CAPACITY: 211 residents

This is a square building with five floors. The first floor has two entrances. The first is on the back side of the building facing Lake Newman. This entrance leads directly into a stairwell. The main entrance is on the front and faces Eagle Hall. Both entrances have stairs only. Through the main entrance, you enter into a vestibule with a stairwell on the left. Through the vestibule is the lobby with a sunken middle area for sitting. On the right wall of the lobby is a lounge area, elevator, and hall director's apartment. On the wall opposite of you is a hallway, - this hallway has a small flight of stairs that leads to the laundry room on the right and trash room on the left - the stairwell that also leads to the other entrance, and the hall office. On the left wall is a hallway of bedrooms with a community bathroom on the left wall of this hallway, and two single occupancy, public bathrooms. On the wall behind you, next to the bathrooms on the left wall, is a hallway. Down this hallway, a kitchen and the laundry room are on your left, and another lounge area is in front of you.

The second through fifth floors are set up in a square hallway with four wings of bedrooms, two community bathrooms in the middle (one men's, one women's), a kitchen, a storage room, and a housekeeping room. When coming out of the elevator, turn to your right. Now, you are facing a hallway with the housekeeping room and kitchen on the left and a wing of bedrooms in front of you at the end of the initial hallway. Also, at the end of the initial hallway is another hallway to your left. Down this hallway, one bathroom is on your left, a stairwell is on your right, and another wing of bedrooms is in front of you at the end. Also at the end is another hallway to your left. Down this hallway, the storage room is on your right. At the end of the hallway is the third wing of bedrooms, and to the left is another hallway. Down this hallway, the other stairwell is on your right, and the other bathroom is on your left. At the end is the last wing of bedrooms, and to the left is your original hallway with the elevator on the right. When entering any wing of bedrooms, there is a small lounge area to the right, and the bedrooms are down the hallway in front of you.