

SHENANDOAH HALL

FIRST FLOOR

#DUKESLIVECLOSE
#DUKESLIVESUPPORTED
#DUKESLIVEON

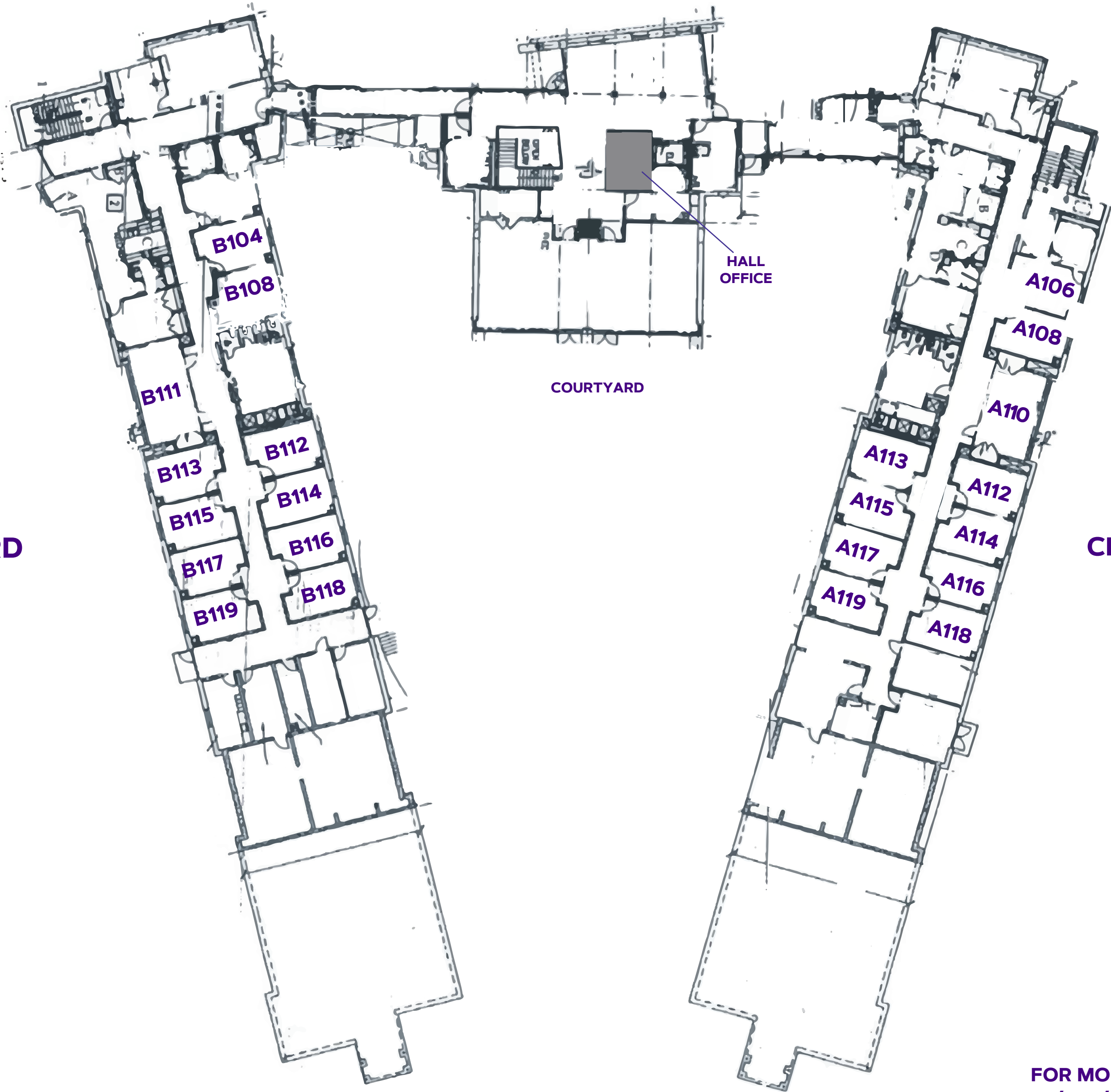

FACES
UNIVERSITY BOULEVARD

FACES
CHESAPEAKE HALL

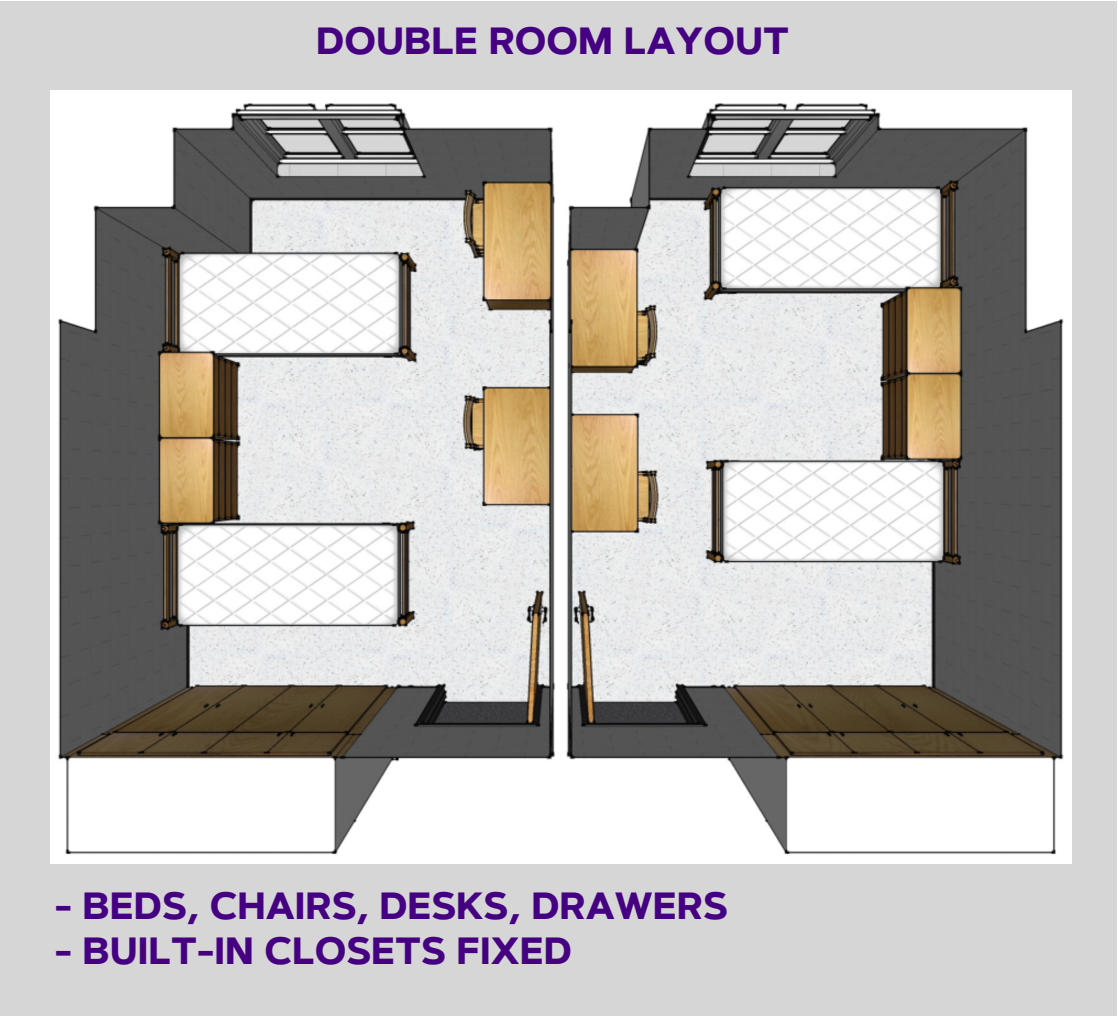

DOUBLE WITH
PRIVATE BATHROOM
(LIMITED QUANTITY)
ROOM SIZE: 11'7" X 12'
WINDOW SIZE: 4'4" X 4'8"
CEILING HEIGHT: 9'3"

DOUBLE WITH HALL
BATHROOM

ROOM SIZE: 11'7" X 15'6"
WINDOW SIZE: 4'4" X 4'8"
CEILING HEIGHT: 9'3"



SHENANDOAH HALL

SECOND FLOOR

#DukesLiveClose
#DukesLiveSupported
#DukesLIVEON

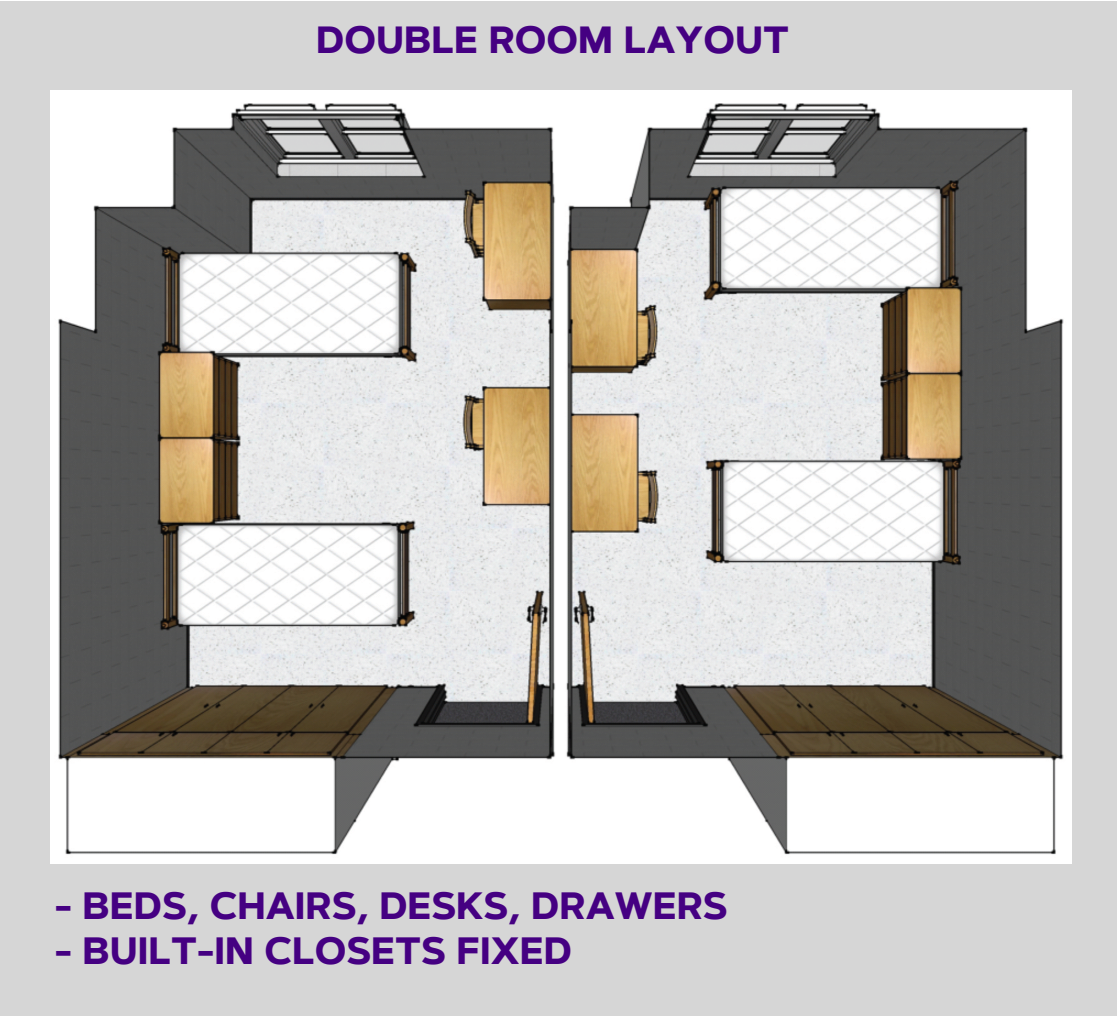
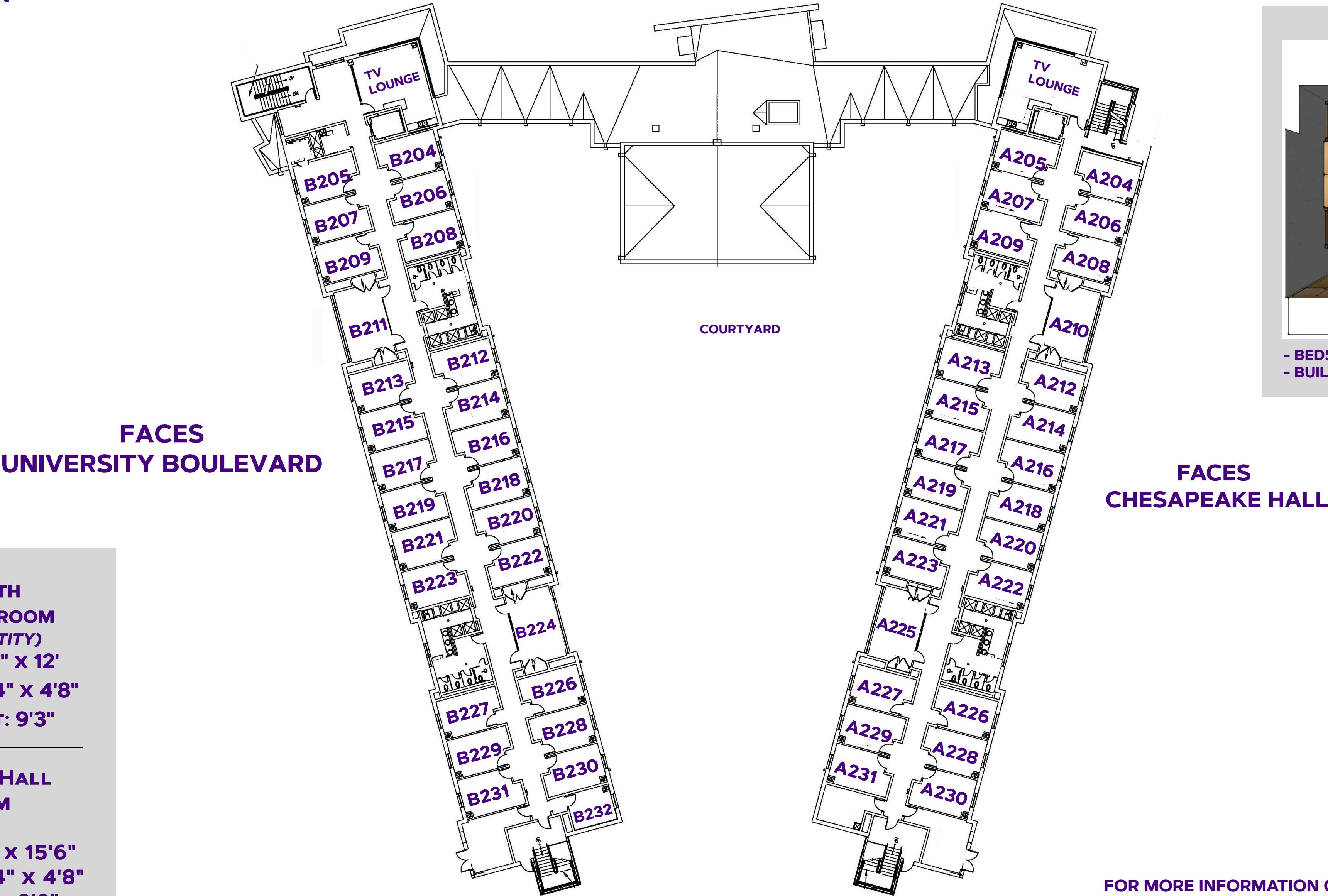

DOUBLE WITH
PRIVATE BATHROOM
(LIMITED QUANTITY)
ROOM SIZE: 11'7" X 12'
WINDOW SIZE: 4'4" X 4'8"
CEILING HEIGHT: 9'3"

DOUBLE WITH HALL
BATHROOM

ROOM SIZE: 11'7" X 15'6"
WINDOW SIZE: 4'4" X 4'8"
CEILING HEIGHT: 9'3"

FOR MORE INFORMATION ON HALLS VISIT:
WWW.JMU.EDU/ORL/OUR-RESIDENCE-HALLS/INDEX.SHTML

SHENANDOAH HALL

THIRD FLOOR

#DukesLiveClose
#DukesLiveSupported
#DukesLIVEON

FACES
UNIVERSITY BOULEVARD

FACES
CHESAPEAKE HALL

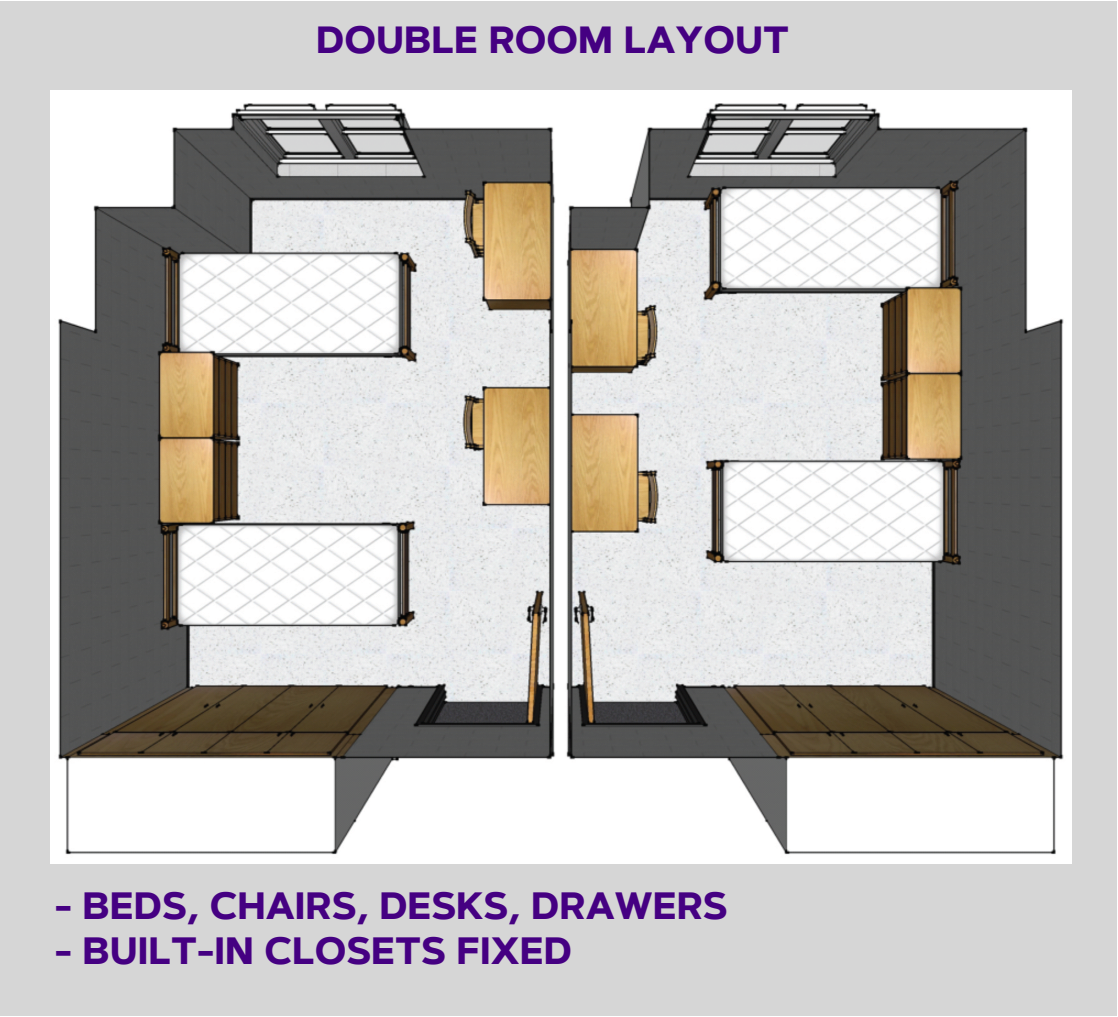
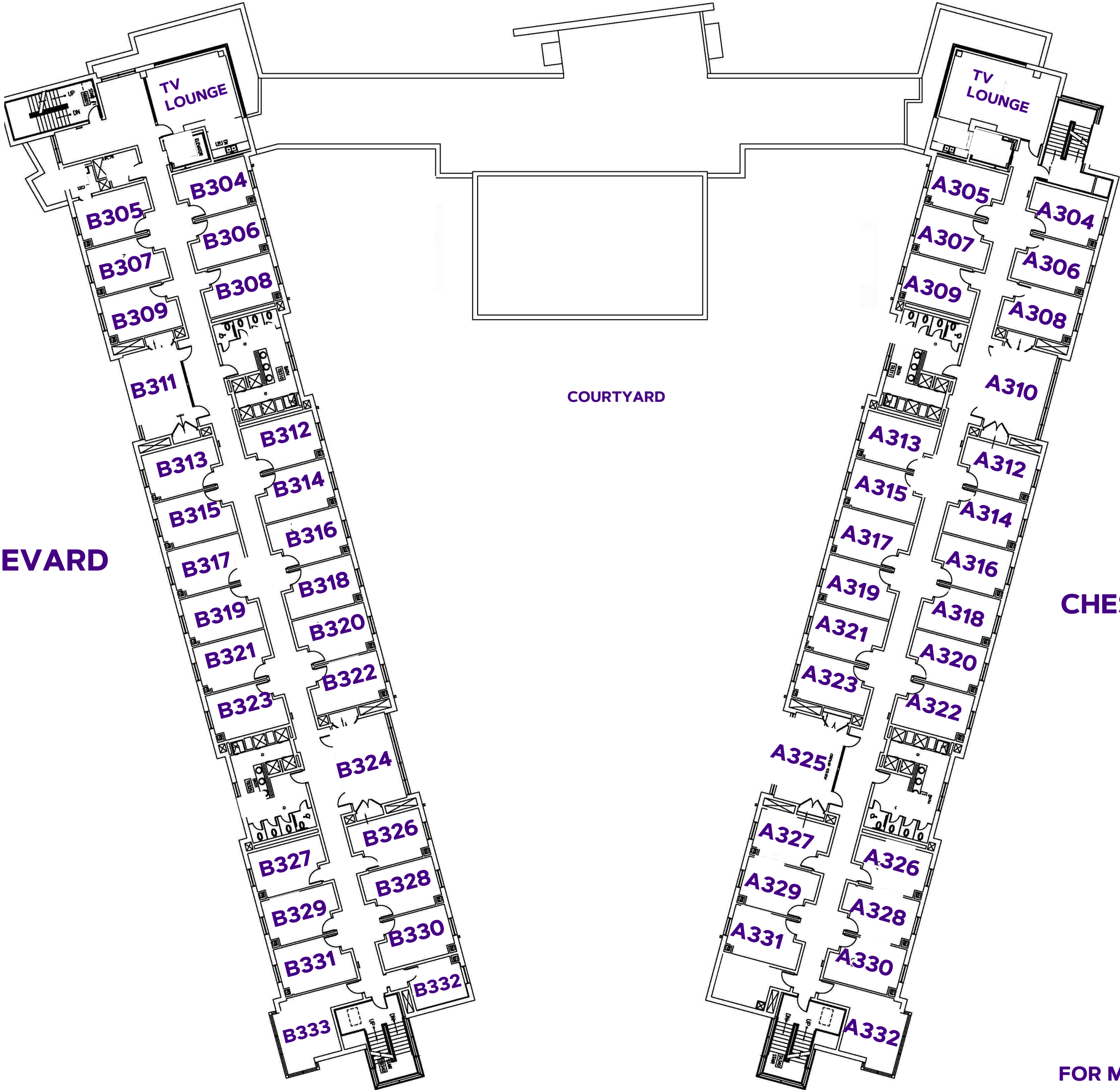

DOUBLE WITH
PRIVATE BATHROOM
(LIMITED QUANTITY)
ROOM SIZE: 11'7" X 12'
WINDOW SIZE: 4'4" X 4'8"
CEILING HEIGHT: 9'3"

DOUBLE WITH HALL
BATHROOM

ROOM SIZE: 11'7" X 15'6"
WINDOW SIZE: 4'4" X 4'8"
CEILING HEIGHT: 9'3"

FOR MORE INFORMATION ON HALLS VISIT:
WWW.JMU.EDU/ORL/OUR-RESIDENCE-HALLS/INDEX.SHTML

SHENANDOAH HALL

FOURTH FLOOR

#DukesLiveClose
#DukesLiveSupported
#DukesLIVEON

FACES
UNIVERSITY BOULEVARD

FACES
CHESAPEAKE HALL

DOUBLE WITH
PRIVATE BATHROOM
(LIMITED QUANTITY)
ROOM SIZE: 11'7" X 12'
WINDOW SIZE: 4'4" X 4'8"
CEILING HEIGHT: 9'3"

DOUBLE WITH HALL
BATHROOM

ROOM SIZE: 11'7" X 15'6"
WINDOW SIZE: 4'4" X 4'8"
CEILING HEIGHT: 9'3"

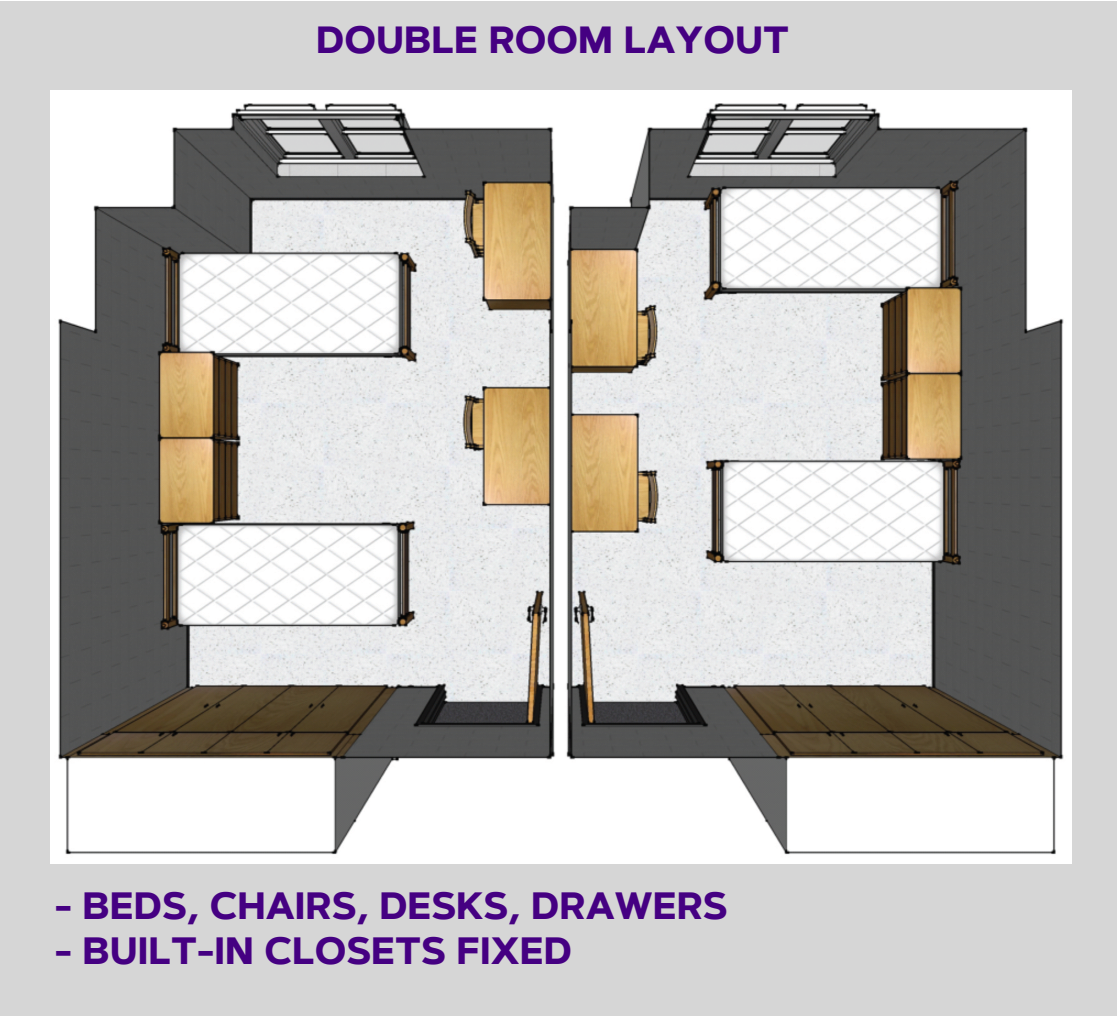
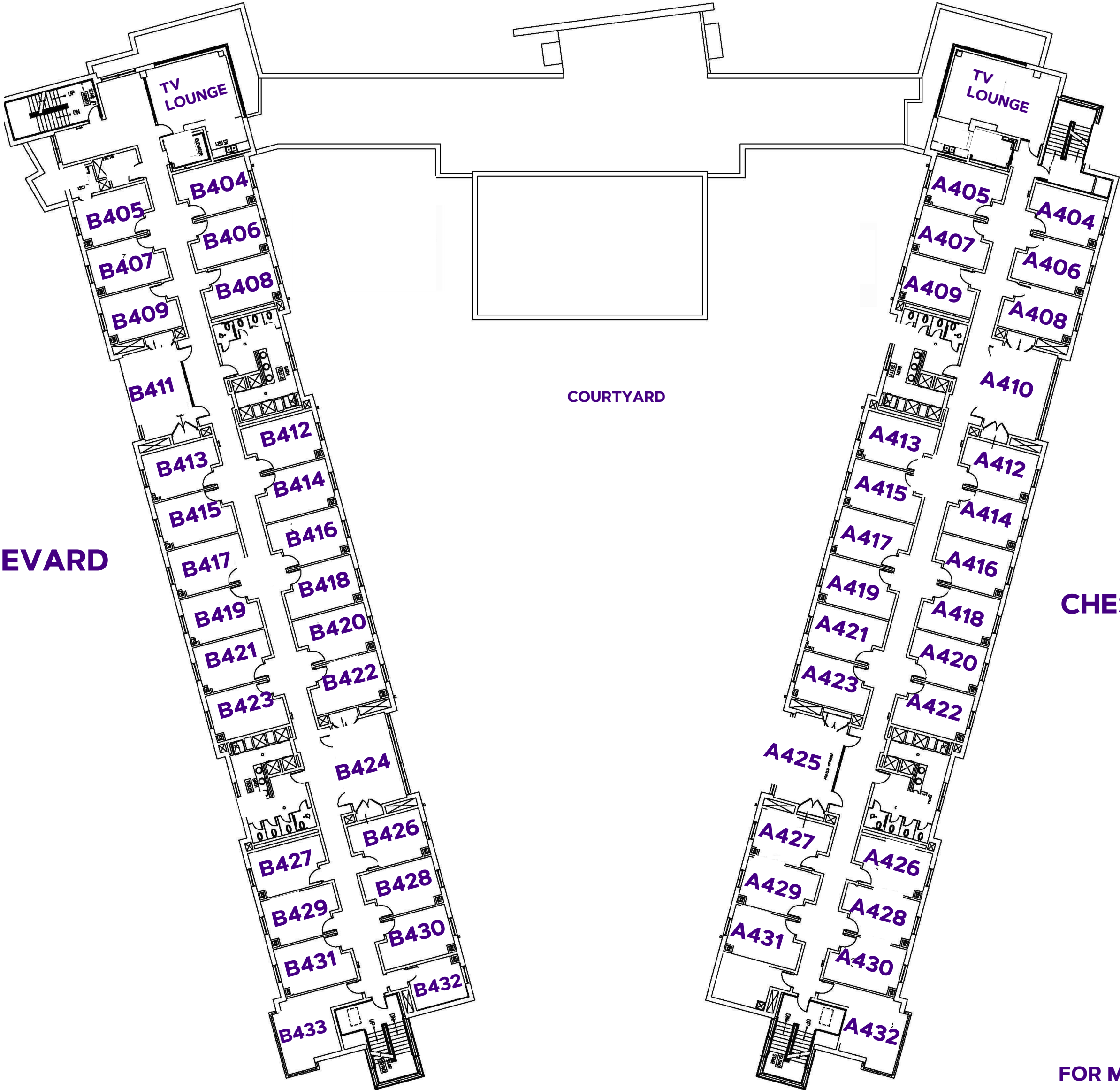

FOR MORE INFORMATION ON HALLS VISIT:
WWW.JMU.EDU/ORL/OUR-RESIDENCE-HALLS/INDEX.SHTML

SHENANDOAH HALL

FIFTH FLOOR

#DukesLiveClose
#DukesLiveSupported
#DukesLIVEON

FACES
UNIVERSITY BOULEVARD

FACES
CHESAPEAKE HALL

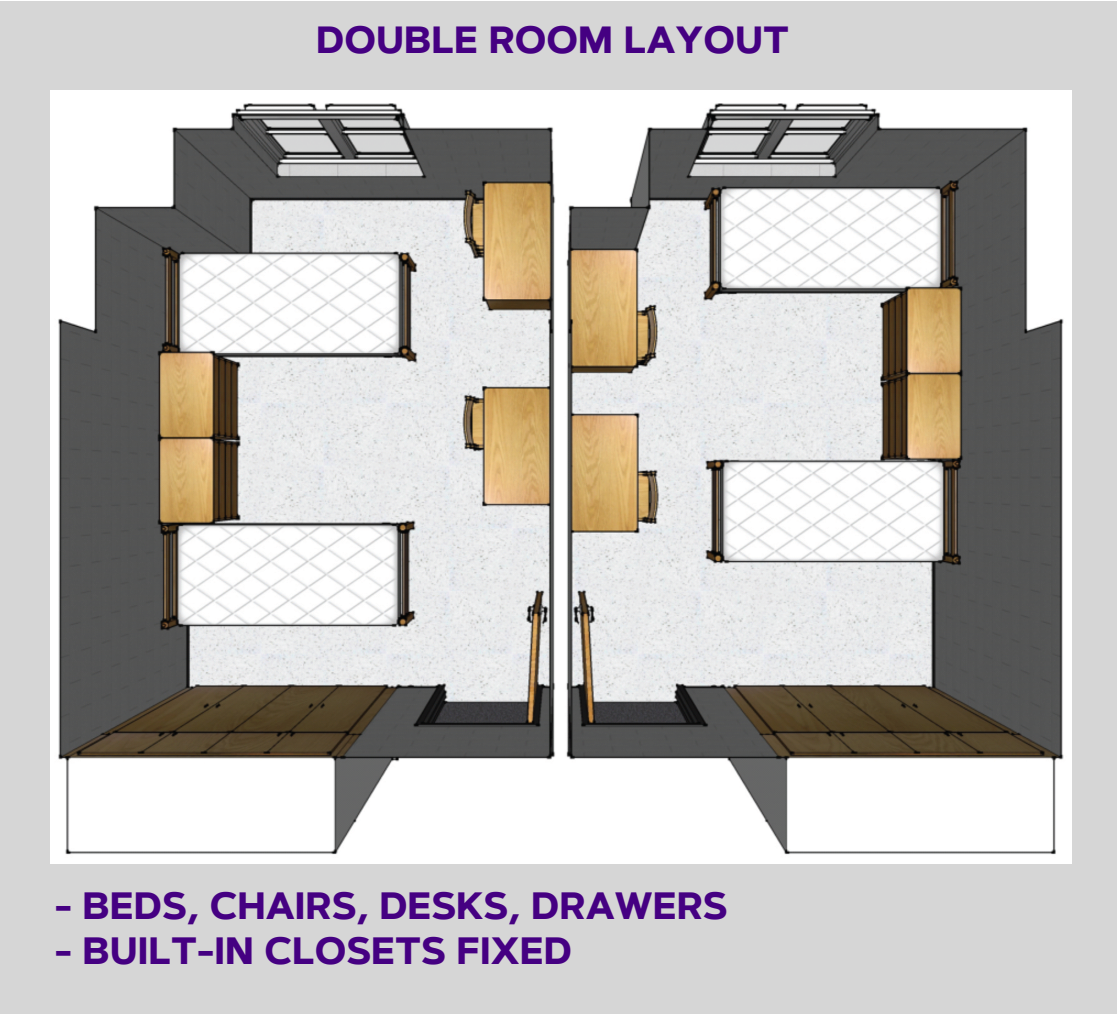
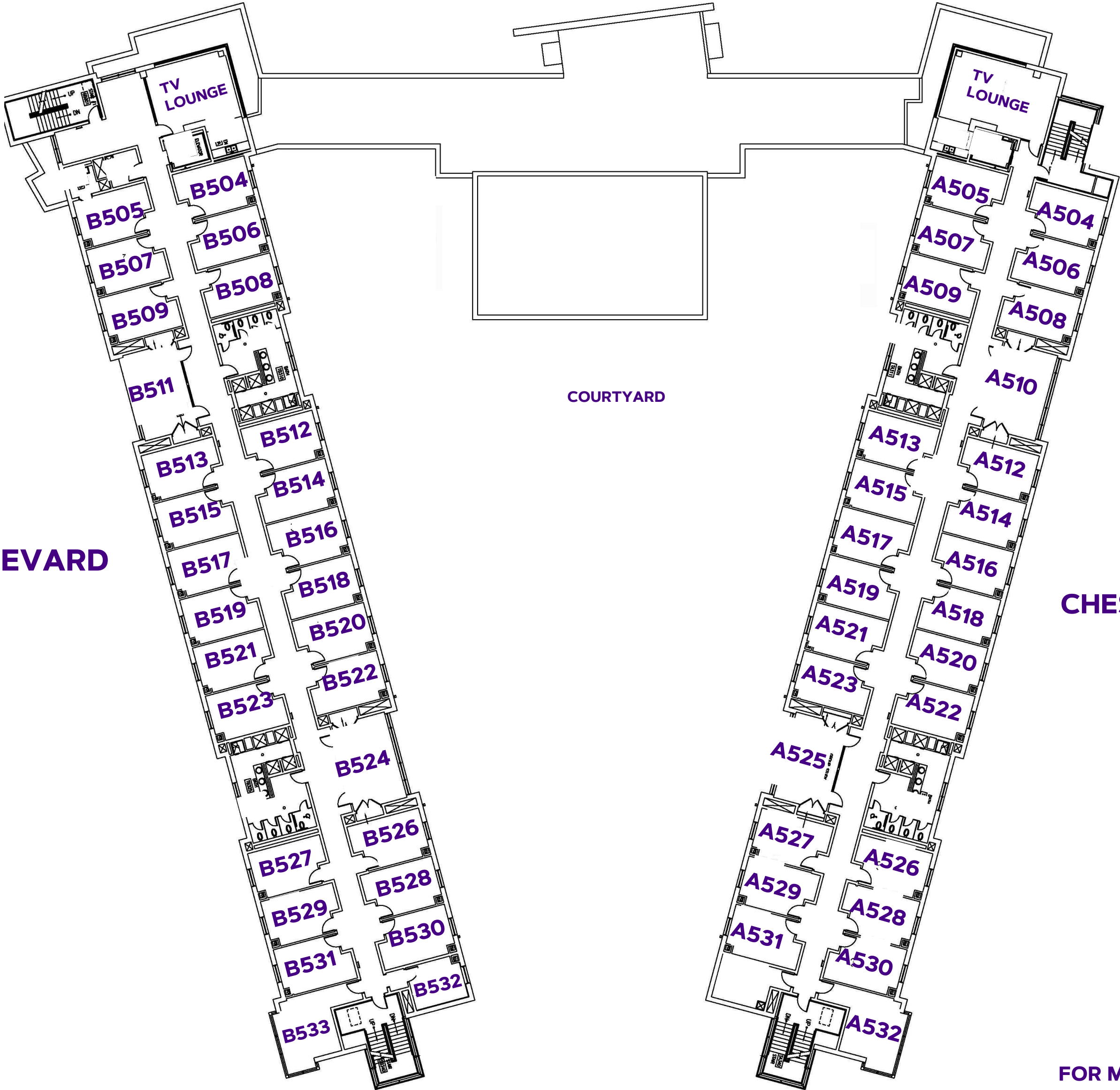

DOUBLE WITH
PRIVATE BATHROOM
(LIMITED QUANTITY)
ROOM SIZE: 11'7" X 12'
WINDOW SIZE: 4'4" X 4'8"
CEILING HEIGHT: 9'3"

DOUBLE WITH HALL
BATHROOM

ROOM SIZE: 11'7" X 15'6"
WINDOW SIZE: 4'4" X 4'8"
CEILING HEIGHT: 9'3"

FOR MORE INFORMATION ON HALLS VISIT:
WWW.JMU.EDU/ORL/OUR-RESIDENCE-HALLS/INDEX.SHTML