

# LOGAN HALL

## BASEMENT

BACK ENTRANCE  
FACES PARKING LOT.

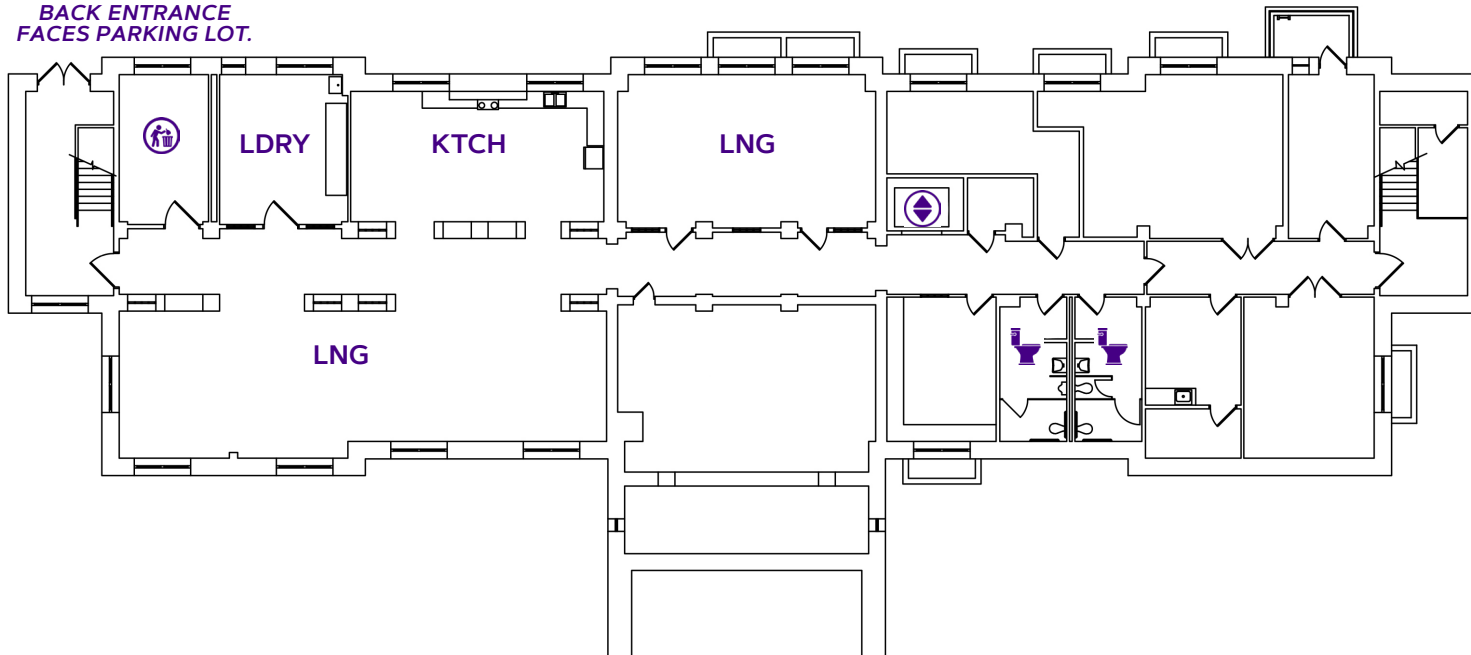

### LEGEND:





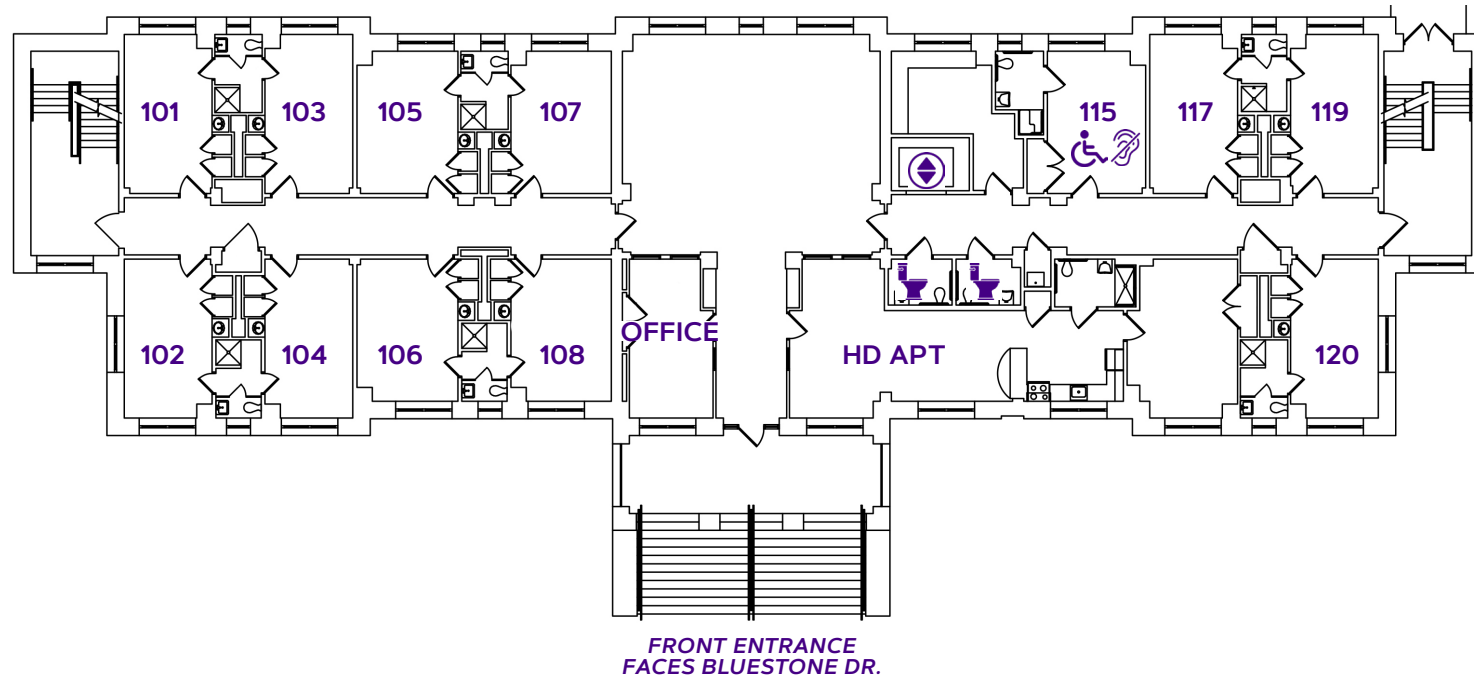

- : Bathroom
- : Elevator
- : Mechanical Space/Misc. Use
- : Trash Room/Disposal Area
- : ADA Accessible Space
- : Hearing Equipment
- HD:** Hall Director
- KTCH:** Kitchen/Kitchenette
- LDRY:** Laundry Room
- LNG:** Lounge  
Study Space/Room  
Programming Space

# LOGAN HALL

## FLOOR ONE



### LEGEND:





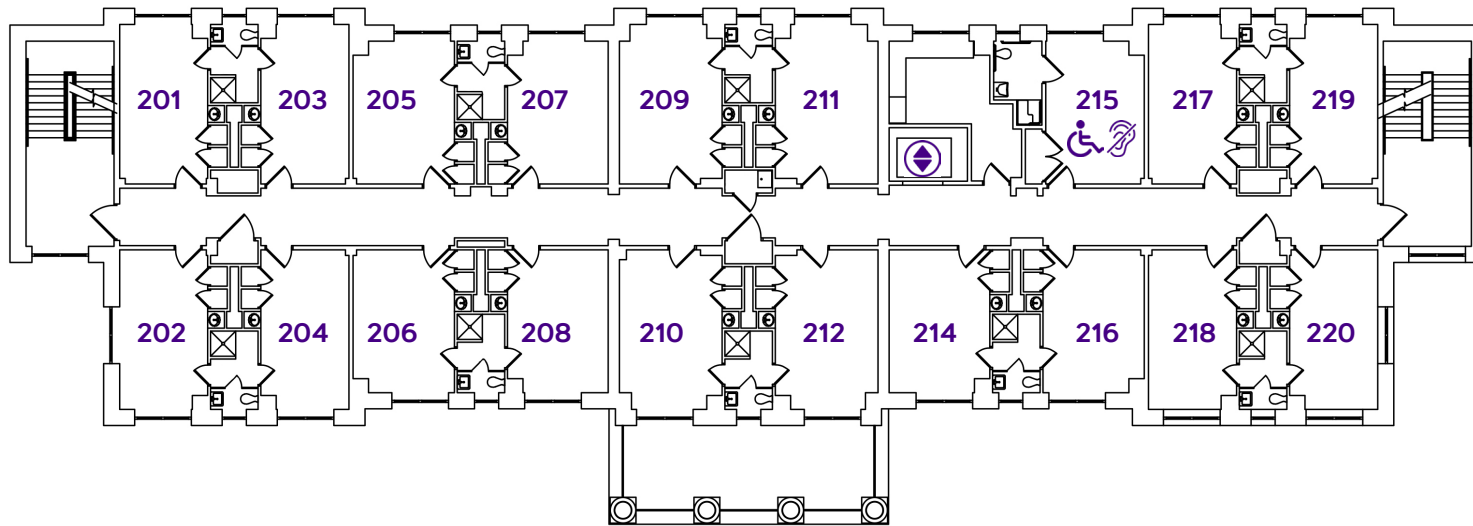

-  :Bathroom
-  :Elevator
-  :Mechanical Space/Misc. Use
-  :Trash Room/Disposal Area
-  :ADA Accessible Space
-  :Hearing Equipment
- HD:** Hall Director
- KTCH:** Kitchen/Kitchenette
- LDRY:** Laundry Room
- LNG:** Lounge  
Study Space/Room  
Programming Space

# LOGAN HALL

## FLOOR TWO



### LEGEND:

-  :Bathroom
-  :Elevator
-  :Mechanical Space/Misc. Use
-  :Trash Room/Disposal Area
-  :ADA Accessible Space
-  :Hearing Equipment
- HD:** Hall Director
- KTCH:** Kitchen/Kitchenette
- LDRY:** Laundry Room
- LNG:** Lounge  
Study Space/Room  
Programming Space

# LOGAN HALL

## FLOOR THREE

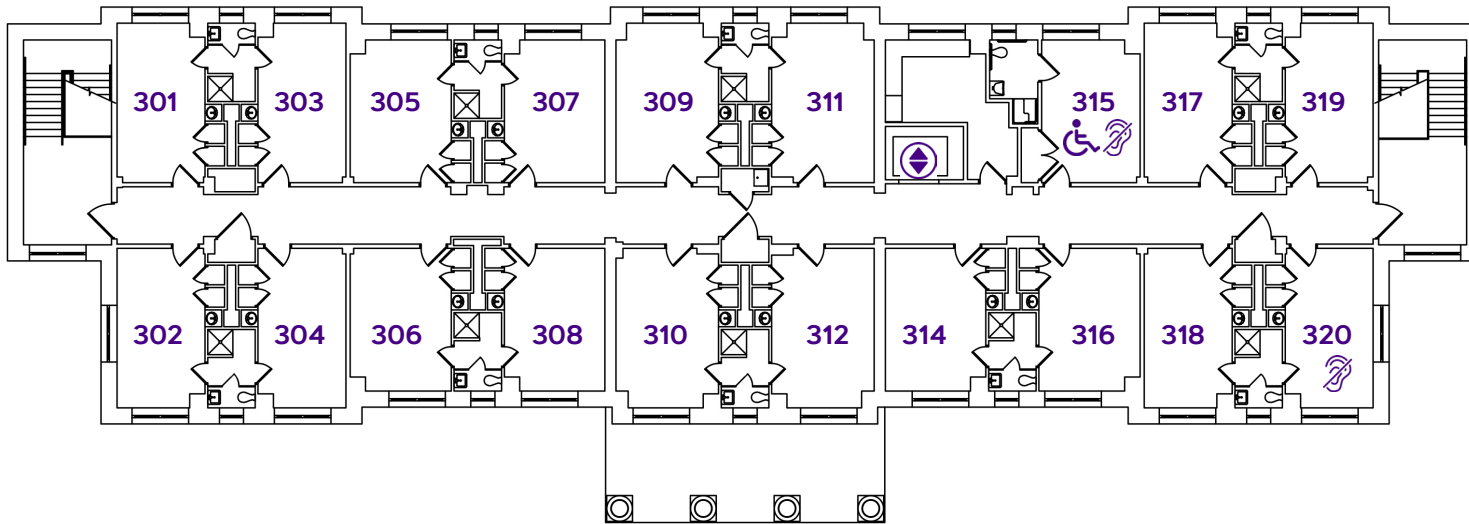

### LEGEND:

- :Bathroom
- :Elevator
- :Mechanical Space/Misc. Use
- :Trash Room/Disposal Area
- :ADA Accessible Space
- :Hearing Equipment
- HD:** Hall Director
- KTCH:** Kitchen/Kitchenette
- LDRY:** Laundry Room
- LNG:** Lounge  
Study Space/Room  
Programming Space



Residence Life

# LOGAN HALL

## ACCESSIBLE DESCRIPTION OF FLOOR PLAN

---

**COMPLETED:** 1951, Renovated in 2004

**CAPACITY:** 97 residents

This is a rectangular building with three floors and a basement. There is one entrance to the basement on the back side facing the parking lot; it has only stairs. After entering through this door, you are in a stairwell. To the left is a door that leads into the main basement area. You are now facing a long hallway. On the left of this hallway is a trash room, laundry room, kitchen, classroom, elevator, and mechanical spaces. On the right is a large lounge area, study room, men's bathroom, women's bathroom, and mechanical spaces. There is a stairwell at the end of the hallway. This stairwell has a door leading outside up one flight of stairs.

The first floor has one entrance on the front facing the road; it has only stairs. When entering here, the hall office is on your left and the hall director's apartment is on our right. A hallway and large lounge area is in front of you. The left hallway is only bedrooms and a stairwell at the end. Immediately entering the right hallway, the elevator and a study room is on your left and two individual, public bathrooms are on your right. At the end of the hallway is a stairwell.

The second and third floors are set up the same with bedrooms replacing the lobby, hall office, and lounge.