

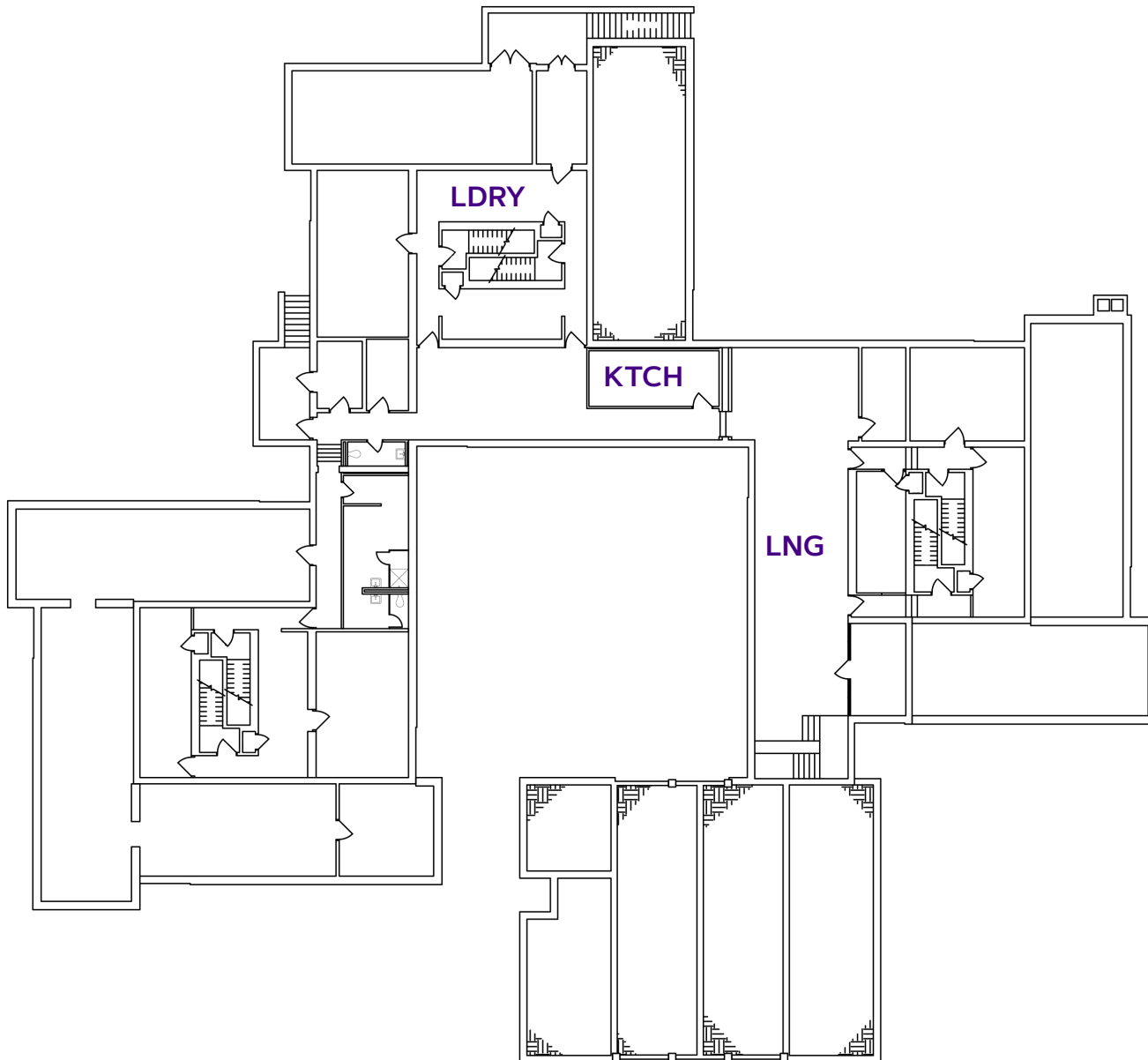





HUFFMAN HALL

BASEMENT



LEGEND:

-  : Bathroom
-  : Elevator
-  : Mechanical Space/Misc. Use
-  : Trash Room/Disposal Area
-  : ADA Accessible Space
-  : Hearing Equipment
- HD:** Hall Director
- KTCH:** Kitchen/Kitchenette
- LDRY:** Laundry Room
- LNG:** Lounge
Study Space/Room
Programming Space

HUFFMAN HALL

FLOOR ONE

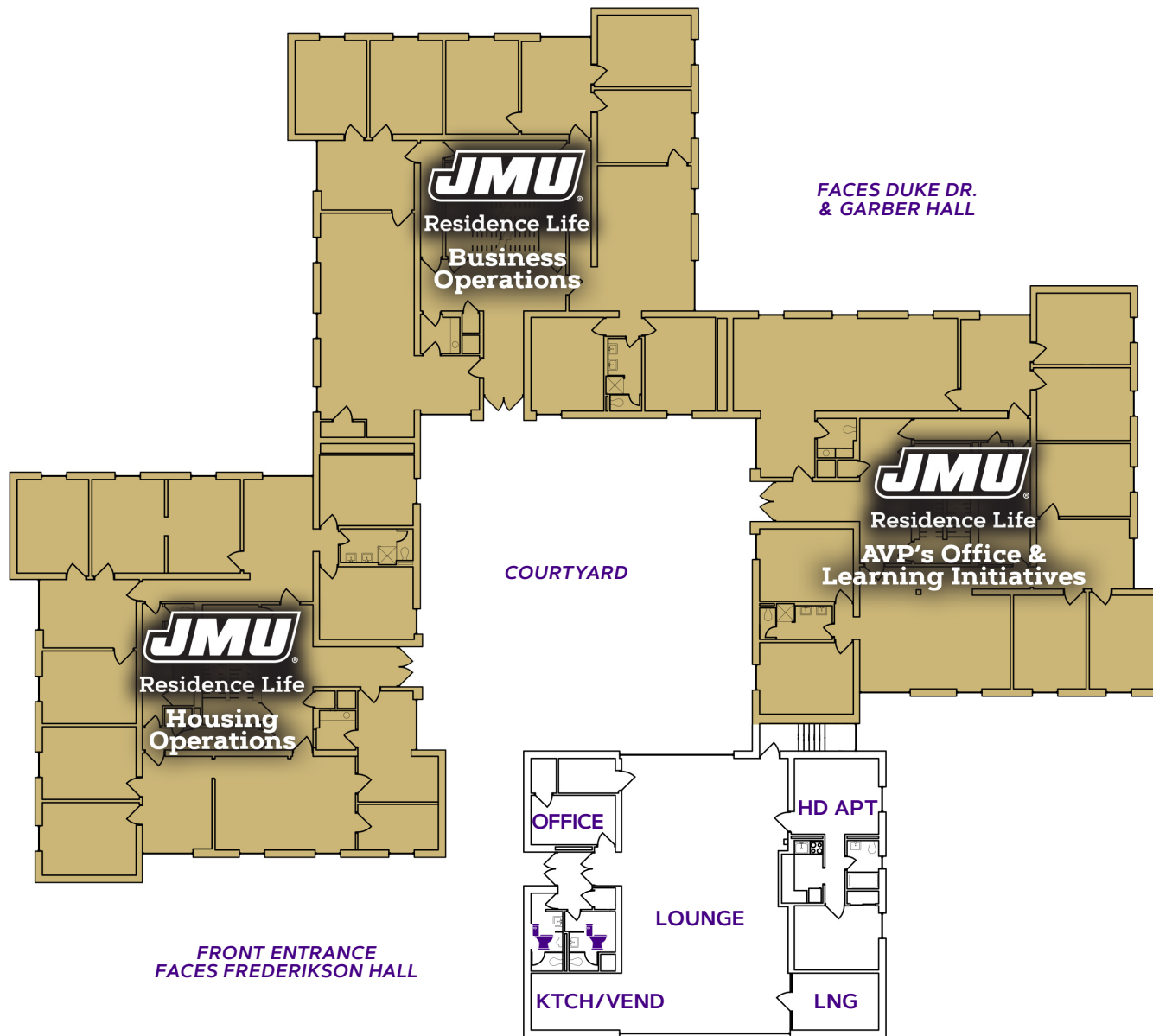

LEGEND:





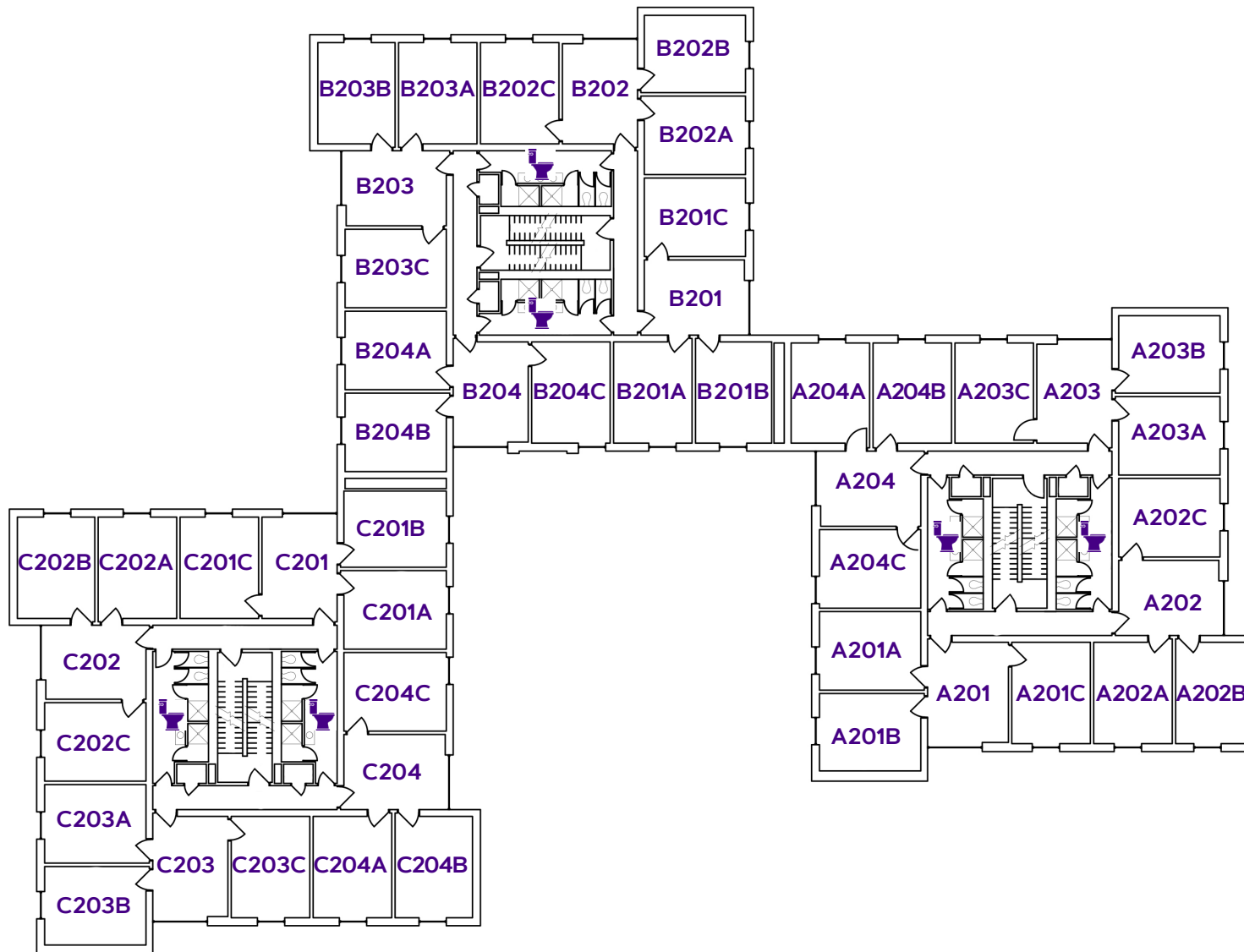

- :Bathroom
- :Elevator
- :Mechanical Space/Misc. Use
- :Trash Room/Disposal Area
- :ADA Accessible Space
- :Hearing Equipment
- HD:** Hall Director
- KTCH:** Kitchen/Kitchenette
- LDRY:** Laundry Room
- LNG:** Lounge
Study Space/Room
Programming Space

HUFFMAN HALL

FLOOR TWO



LEGEND:





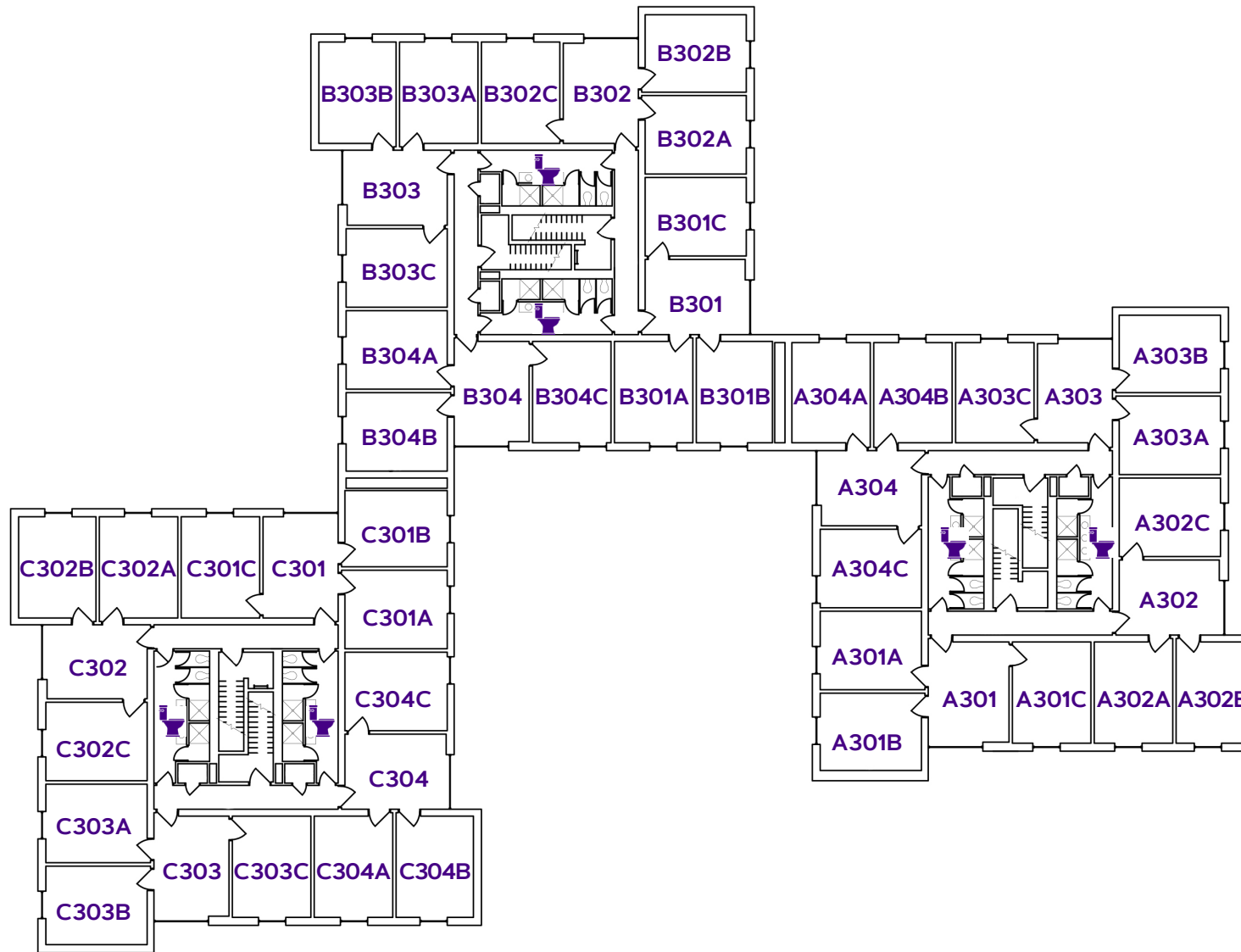

-  :Bathroom
-  :Elevator
-  :Mechanical Space/Misc. Use
-  :Trash Room/Disposal Area
-  :ADA Accessible Space
-  :Hearing Equipment
- HD:** Hall Director
- KTCH:** Kitchen/Kitchenette
- LDRY:** Laundry Room
- LNG:** Lounge
Study Space/Room
Programming Space

HUFFMAN HALL

FLOOR THREE



LEGEND:

-  :Bathroom
-  :Elevator
-  :Mechanical Space/Misc. Use
-  :Trash Room/Disposal Area
-  :ADA Accessible Space
-  :Hearing Equipment
- HD:** Hall Director
- KTCH:** Kitchen/Kitchenette
- LDRY:** Laundry Room
- LNG:** Lounge
Study Space/Room
Programming Space

HUFFMAN HALL

ACCESSIBLE DESCRIPTION OF FLOOR PLAN

COMPLETED: 1966

CAPACITY: 138 residents

This hall is constructed in 4 sections, A,B,C & a lounge around a small courtyard, with steps and brick sidewalks to each section. The lounge is on the right before you enter the courtyard and contains the TV/recreation lounge, Hall Office, Vending, a private glass study lounge, 2 public bathrooms and the Hall Director apartment. There is a stairwell, accessed by card reader, in the left corner of the lounge that leads to the basement. The basement contains a large study lounge, glass room study, laundry room, community kitchen, inside bike rack, storage rooms, laundry services, housekeeping break room and an exit to a back stairwell that leads you to the dumpster outside.

As you enter the courtyard, through a covered breezeway, you will find C section to the left, B section straight ahead, and A section to the right. The first floor of all 3 sections contains the offices of Residence Life; A section is the AVP's office, Learning Initiatives and the Resource Center, B section is Business Operations and the Madison room meeting space. C section is Housing and Community Development. There is a community water fountain in the center of the lobby, between the stairwell doors of each section. To reach suites, 201-202 and 303-304, there is a card access controlled door on the left side of the lobby. For suites 203-204 and 301-302, the card access controlled door is on the right side. These suites are typically 3 double rooms that share a common room in the middle, that is behind a locked door. There are community bathrooms, in-between 2 suites shared by those 2 suites.