

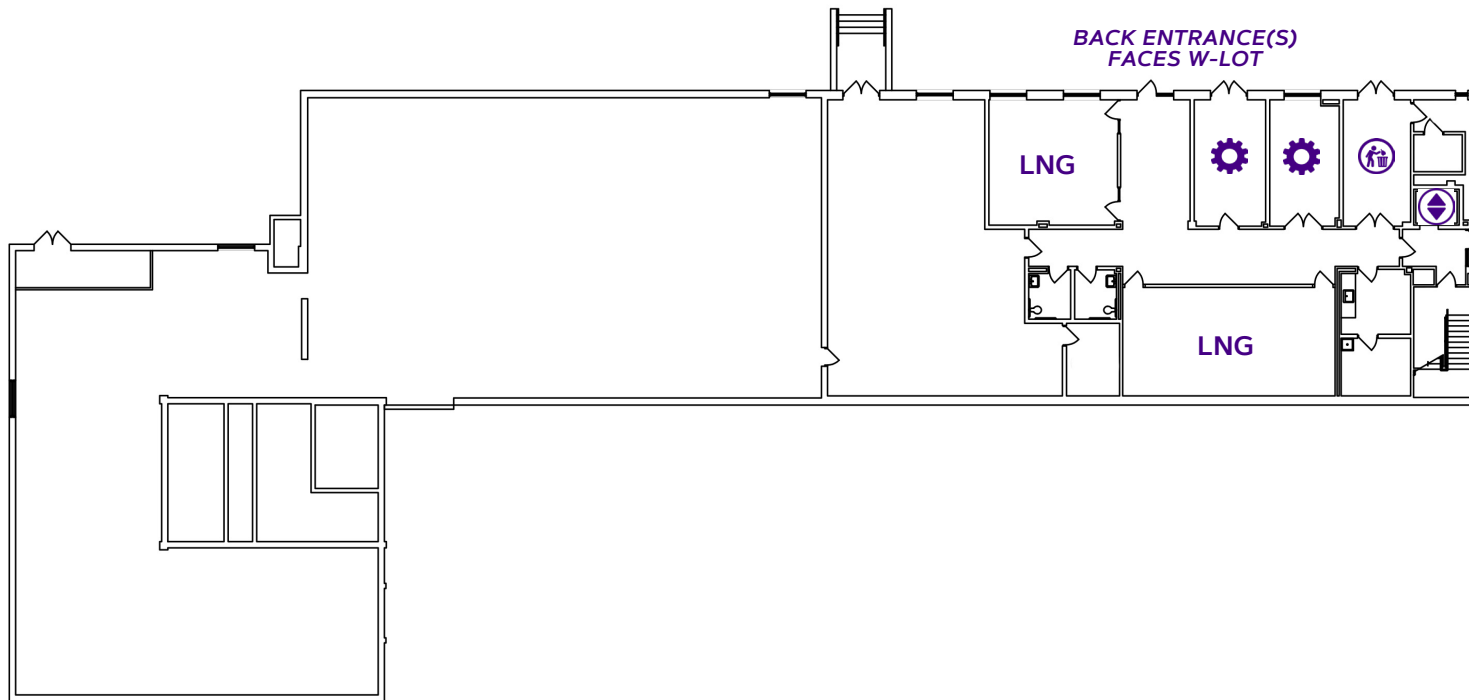





HOFFMAN HALL

BASEMENT



LEGEND:

-  :Bathroom
-  :Elevator
-  :Mechanical Space/Misc. Use
-  :Trash Room/Disposal Area
-  :ADA Accessible Space
-  :Hearing Equipment
- HD:** Hall Director
- KTCH:** Kitchen/Kitchenette
- LDRY:** Laundry Room
- LNG:** Lounge
Study Space/Room
Programming Space



Residence Life

HOFFMAN HALL

FLOOR ONE

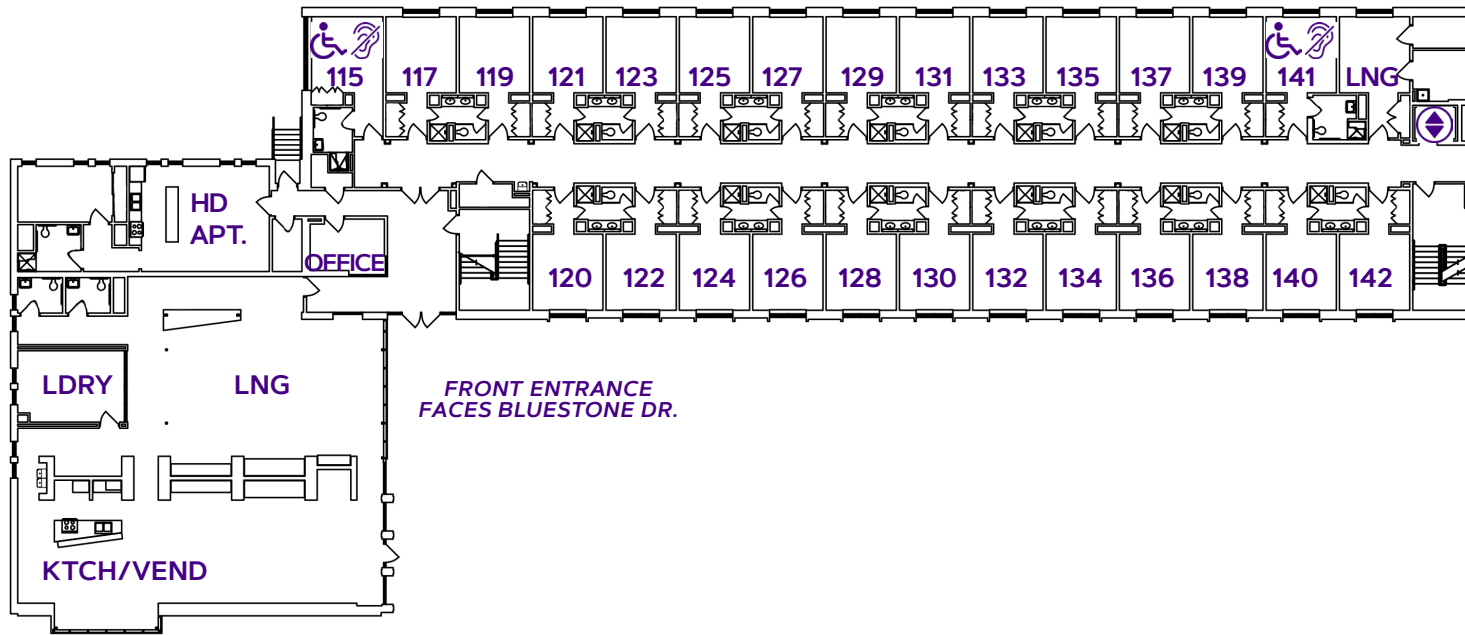

LEGEND:





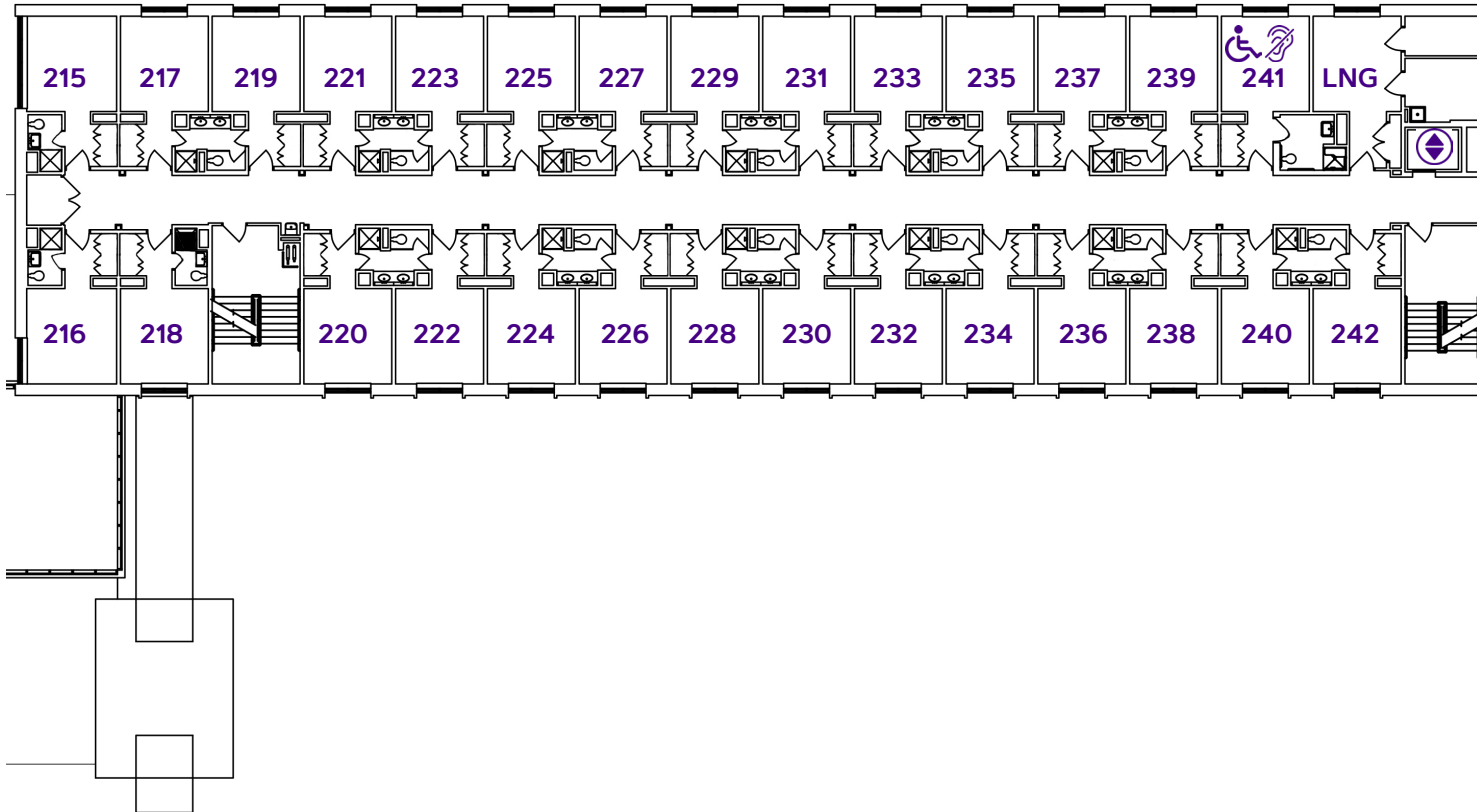

- :Bathroom
- :Elevator
- :Mechanical Space/Misc. Use
- :Trash Room/Disposal Area
- :ADA Accessible Space
- :Hearing Equipment
- HD: Hall Director
- KTCH: Kitchen/Kitchenette
- LDY: Laundry Room
- LNG: Lounge
Study Space/Room
Programming Space

HOFFMAN HALL

FLOOR TWO



LEGEND:





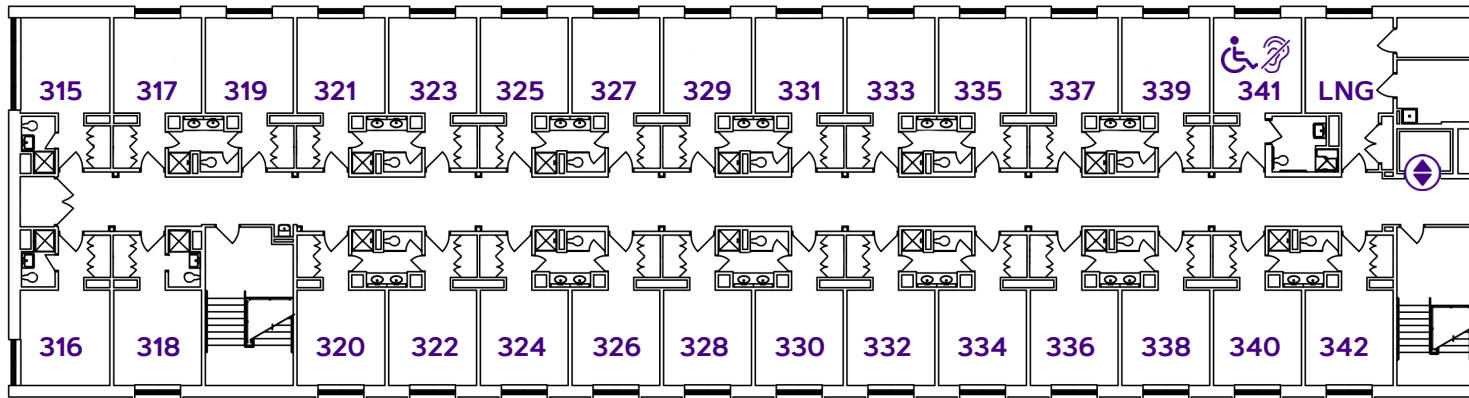

-  :Bathroom
-  :Elevator
-  :Mechanical Space/Misc. Use
-  :Trash Room/Disposal Area
-  :ADA Accessible Space
-  :Hearing Equipment
- HD: Hall Director
- KTCH: Kitchen/Kitchenette
- LDRY: Laundry Room
- LNG: Lounge
Study Space/Room
Programming Space

HOFFMAN HALL

FLOOR THREE



LEGEND:

-  :Bathroom
-  :Elevator
-  :Mechanical Space/Misc. Use
-  :Trash Room/Disposal Area
-  :ADA Accessible Space
-  :Hearing Equipment
- HD: Hall Director
- KTCH: Kitchen/Kitchenette
- LDRY: Laundry Room
- LNG: Lounge
Study Space/Room
Programming Space

HOFFMAN HALL

ACCESSIBLE DESCRIPTION OF FLOOR PLAN

COMPLETED: 1964, Renovated in 2008

CAPACITY: 158 residents

This is a rectangular building with three floors and a basement. There are two entrances to the basement, neither do you require stairs. One entrance is on the side facing Wayland. The other entrance is on the back side facing the parking lot. When entering this door, there is a study room on your right and a hallway in front of you. Down the right of this hallway, there are two individual public bathrooms on the left, and a mechanical space at the end. Down the left of the hallway, there is a classroom and mechanical space on your right, and mechanical spaces and the trash room on your left. There is a door at the end that leads into a vestibule. In this vestibule, the elevator is on your left, the other basement entrance is in front of you, and there is a stairwell on your right.

The first floor has two entrances, both requiring stairs. One entrance is on the back side facing the parking lot. This leads into a hallway with the hall director's apartment and hall office. The main entrance is on the front facing the road. When entering here, there is a stairwell on your right and a lounge area on your left. In the lounge area, in front of you, there are two individual, public bathrooms on the right. Down the left, the laundry room and kitchen are on your right. Back to the entrance, there is a hallway in front of you. Down the left of the hallway is the hall office on the left and hall director's apartment at the end. In front of you is a doorway that leads to the hallway of the bedrooms. Down the right, at the end of the hallway, the stairwell is on the right, and the levator is on the left.

The second and third floors are set up the same as the first-floor hallway of bedrooms. The elevator and one stairwell are at the end of the hallway. The other stairwell is near the other end of the hallway. The rest of the hallway is the bedrooms.