

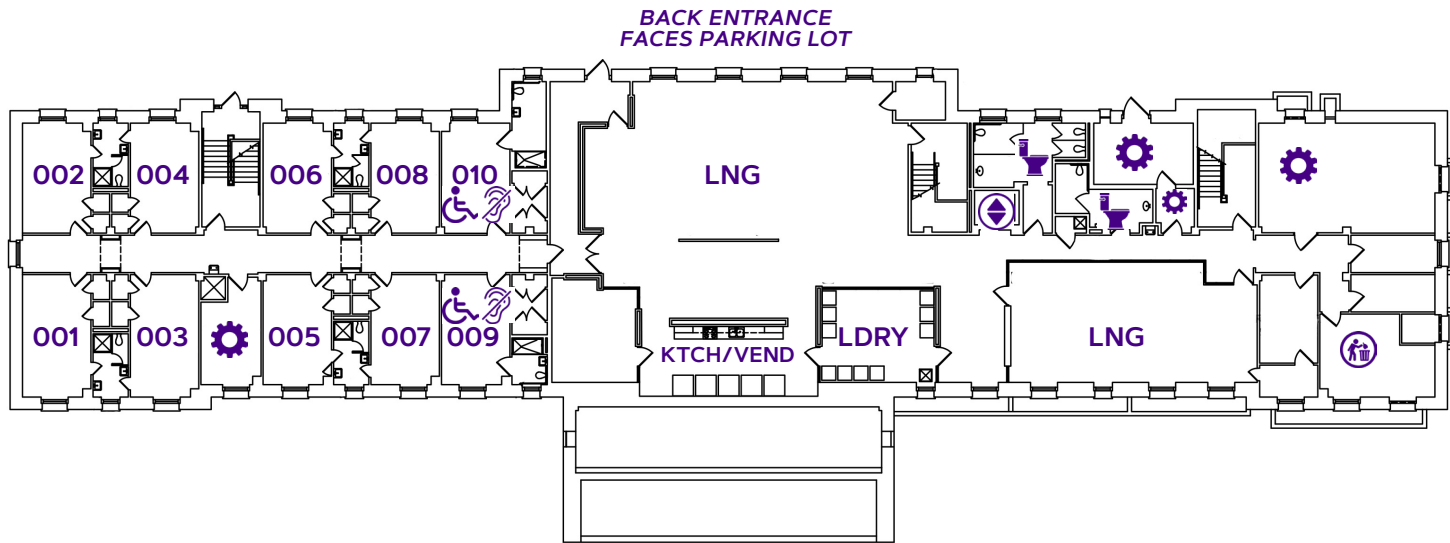





GIFFORD HALL

BASEMENT



LEGEND:

-  : Bathroom
-  : Elevator
-  : Mechanical Space/Misc. Use
-  : Trash Room/Disposal Area
-  : ADA Accessible Space
-  : Hearing Equipment
- HD:** Hall Director
- KTCH:** Kitchen/Kitchenette
- LDRY:** Laundry Room
- LNG:** Lounge
Study Space/Room
Programming Space



Residence Life

GIFFORD HALL

FLOOR ONE

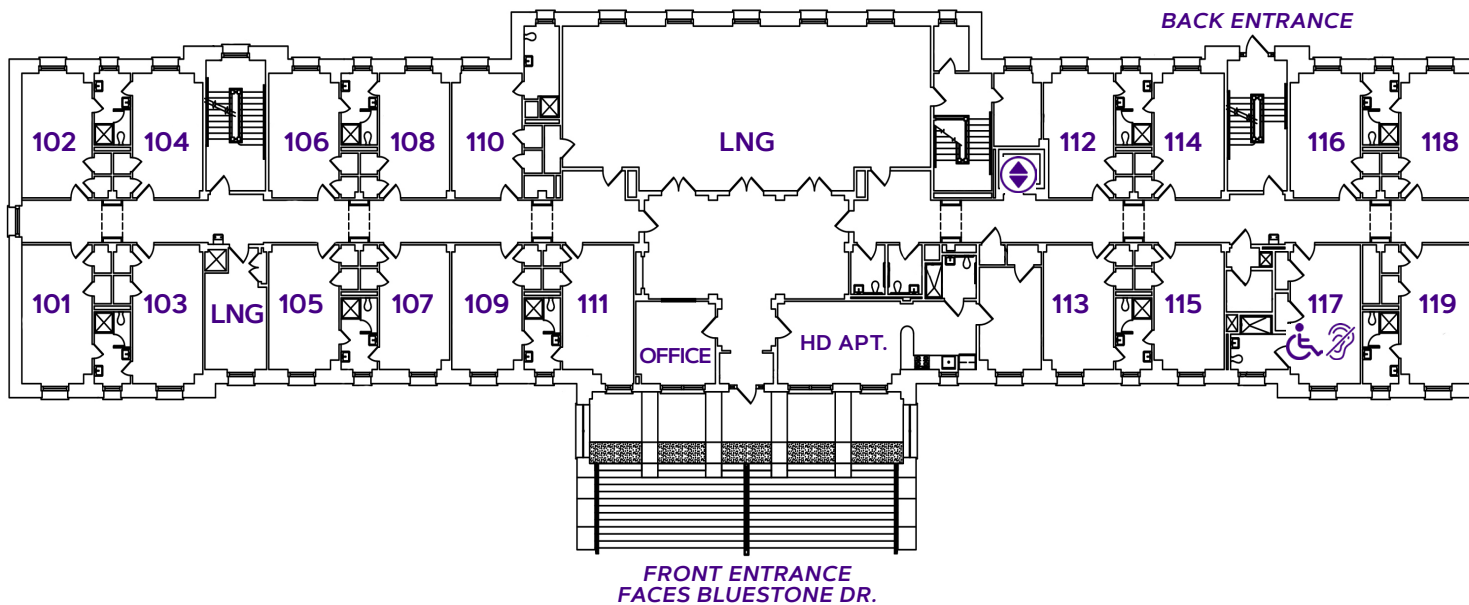

LEGEND:

- : Bathroom
- : Elevator
- : Mechanical Space/Misc. Use
- : Trash Room/Disposal Area
- : ADA Accessible Space
- : Hearing Equipment
- HD:** Hall Director
- KTCH:** Kitchen/Kitchenette
- LDRY:** Laundry Room
- LNG:** Lounge
Study Space/Room
Programming Space







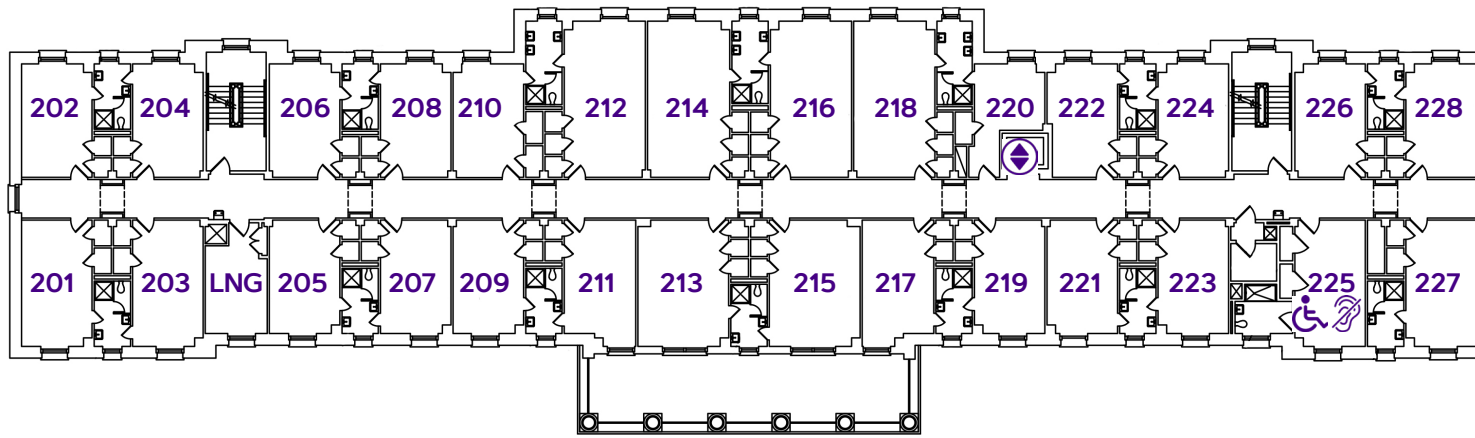

Residence Life

GIFFORD HALL

FLOOR TWO



LEGEND:





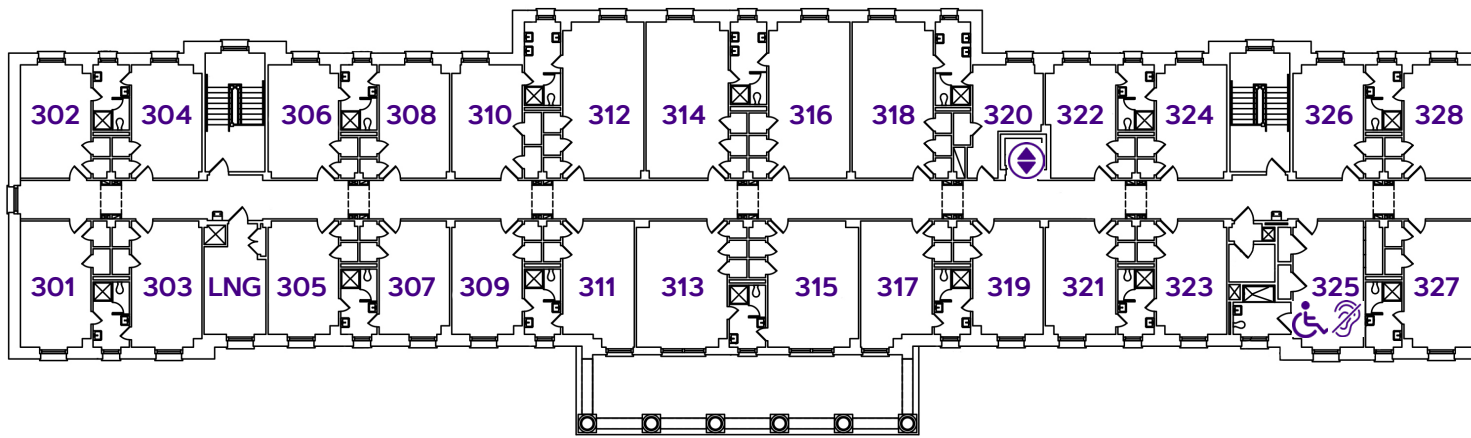

-  :Bathroom
-  :Elevator
-  :Mechanical Space/Misc. Use
-  :Trash Room/Disposal Area
-  :ADA Accessible Space
-  :Hearing Equipment
- HD:** Hall Director
- KTCH:** Kitchen/Kitchenette
- LDRY:** Laundry Room
- LNG:** Lounge
Study Space/Room
Programming Space

GIFFORD HALL

FLOOR THREE



LEGEND:

-  :Bathroom
-  :Elevator
-  :Mechanical Space/Misc. Use
-  :Trash Room/Disposal Area
-  :ADA Accessible Space
-  :Hearing Equipment
- HD:** Hall Director
- KTCH:** Kitchen/Kitchenette
- LDRY:** Laundry Room
- LNG:** Lounge
Study Space/Room
Programming Space

GIFFORD HALL

ACCESSIBLE DESCRIPTION OF FLOOR PLAN

COMPLETED: 1935, Renovated in 2002

CAPACITY: 174 residents

This is a rectangular building with three floors and a basement. There are two entrances into the basement on the back side of the building facing the parking lot. The entrance on the right leads into a stairwell that leads into a hallway of bedrooms when you go up or down the stairs. The middle entrance leads into a corridor. Following the corridor straight, you will come to another corridor going left and right. Down the right corridor is a hallway of bedrooms. Near the end of this hallway is a stairwell. Going left leads you to the lounge area. Turning left when entering through the middle entrance will also lead you to the lounge. Standing in the corridor facing the lounge, the kitchen, vending, and laundry rooms are on the right. The lounge is on your left. Past the lounge, there is a classroom, storage space, and trash room on the right. The trash room is past the storage room and is around the corner. On the left is the elevator, a women's restroom, a men's restroom, and a stairwell. The rest of the doors lead to mechanical spaces.

The first floor has one entrance at the front facing the road. This entrance has only stairs. From this entrance, you enter the vestibule which leads to the lobby. To the left is the office; to the right is the Hall Director's apartment. Moving into the lobby, there is a large lounge directly in front of you. To either side of you is a hallway of bedrooms. The hallway on the left is all bedrooms with a stairwell near the end on the right and a study room across from the stairwell. The hallway on the right has all bedrooms and a stairwell on the left. Just before entering the right hallway, there is a stairwell and elevator on the left and two individual, public bathrooms on the right.

The second and third floors are all bedrooms. There is a stairwell on both ends of each floor. The elevator is in the middle right of the floors and there is a study room across from the stairwell on the left of the hallway.