

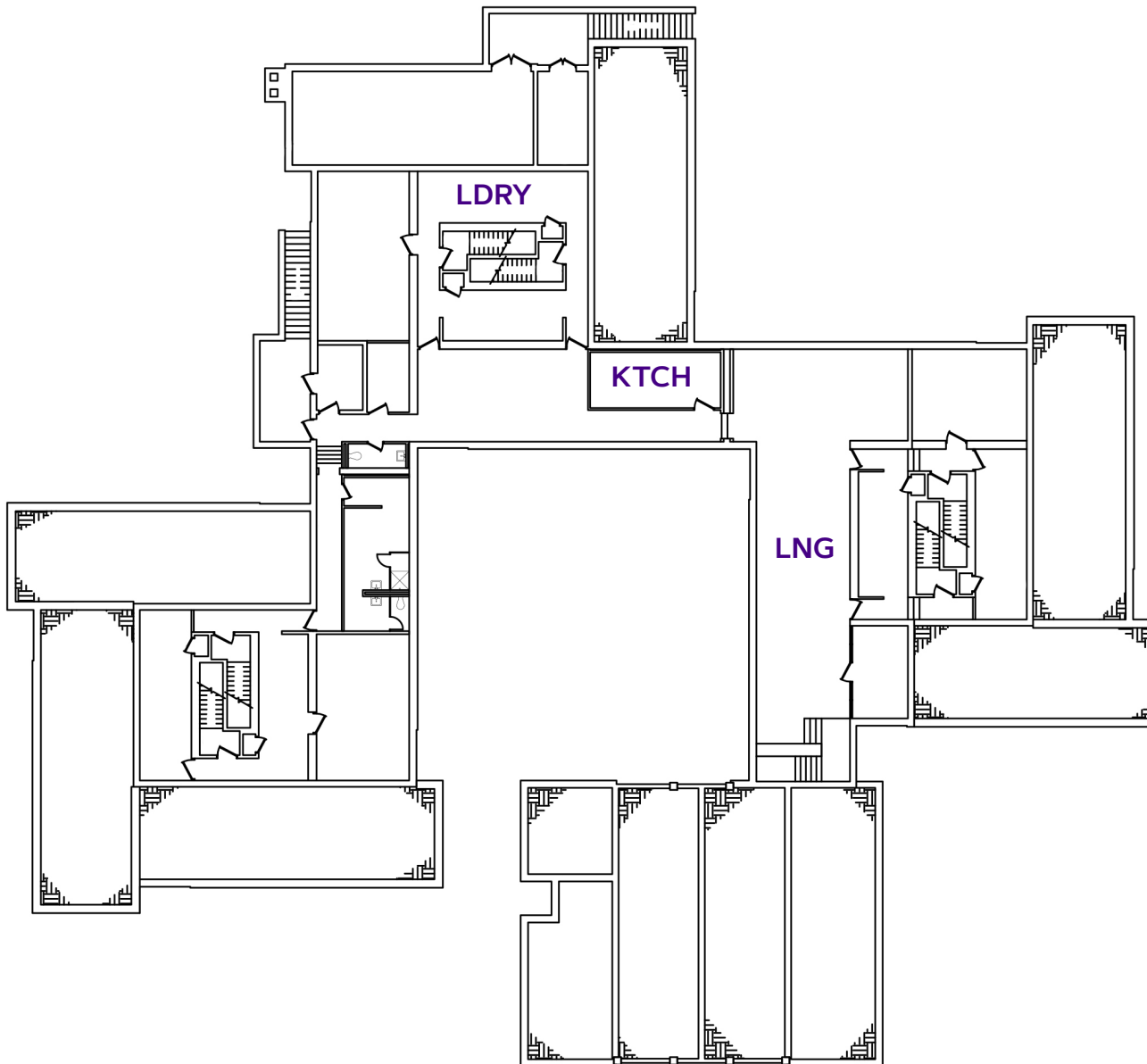





GARBER HALL

BASEMENT



LEGEND:





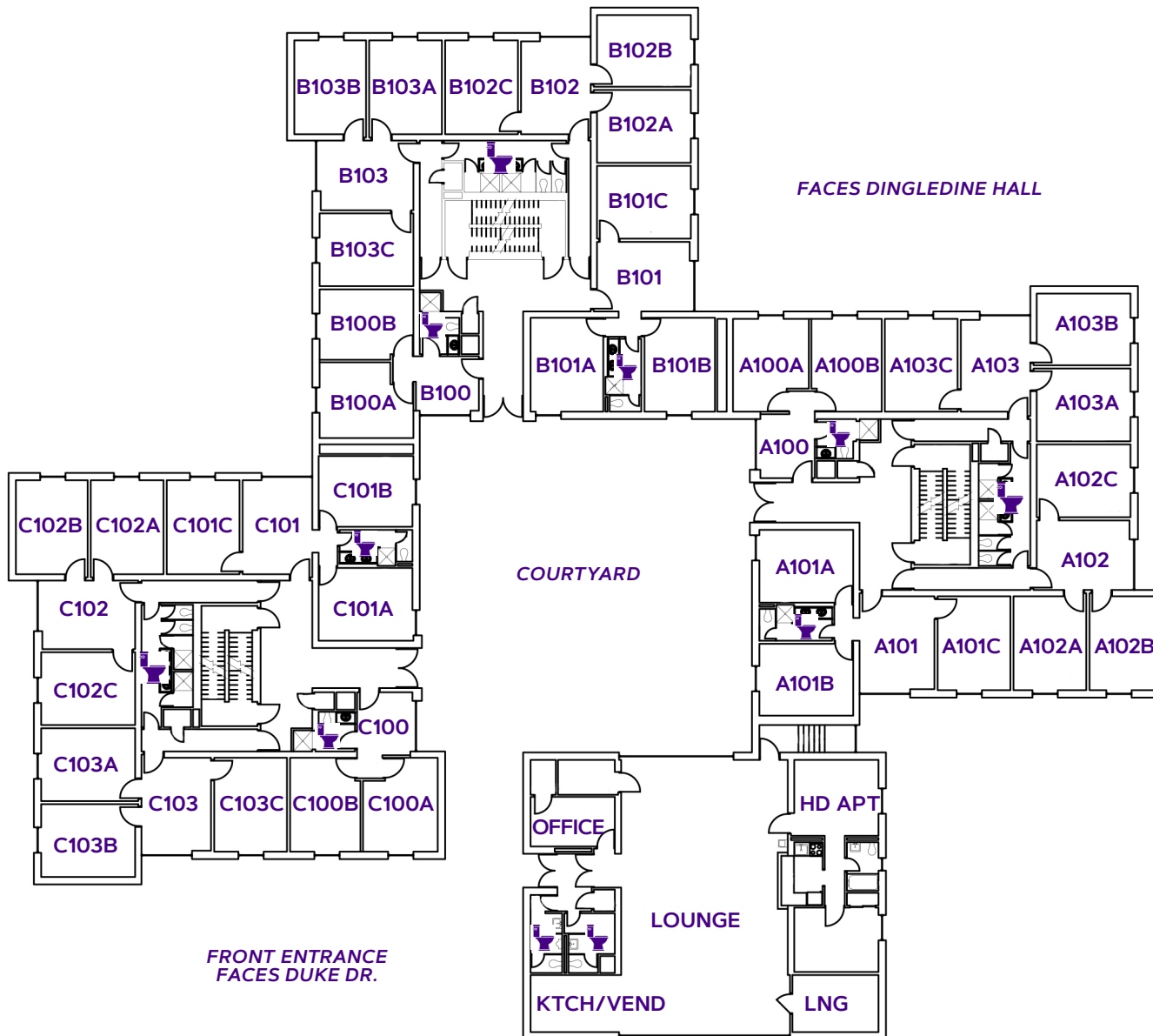

-  :Bathroom
-  :Elevator
-  :Mechanical Space/Misc. Use
-  :Trash Room/Disposal Area
-  :ADA Accessible Space
-  :Hearing Equipment
- HD:** Hall Director
- KTCH:** Kitchen/Kitchenette
- LDRY:** Laundry Room
- LNG:** Lounge
Study Space/Room
Programming Space

GARBER HALL

FLOOR ONE



LEGEND:

-  :Bathroom
-  :Elevator
-  :Mechanical Space/Misc. Use
-  :Trash Room/Disposal Area
-  :ADA Accessible Space
-  :Hearing Equipment
- HD:** Hall Director
- KTCH:** Kitchen/Kitchenette
- LDRY:** Laundry Room
- LNG:** Lounge
 - Study Space/Room
 - Programming Space

GARBER HALL

FLOOR TWO

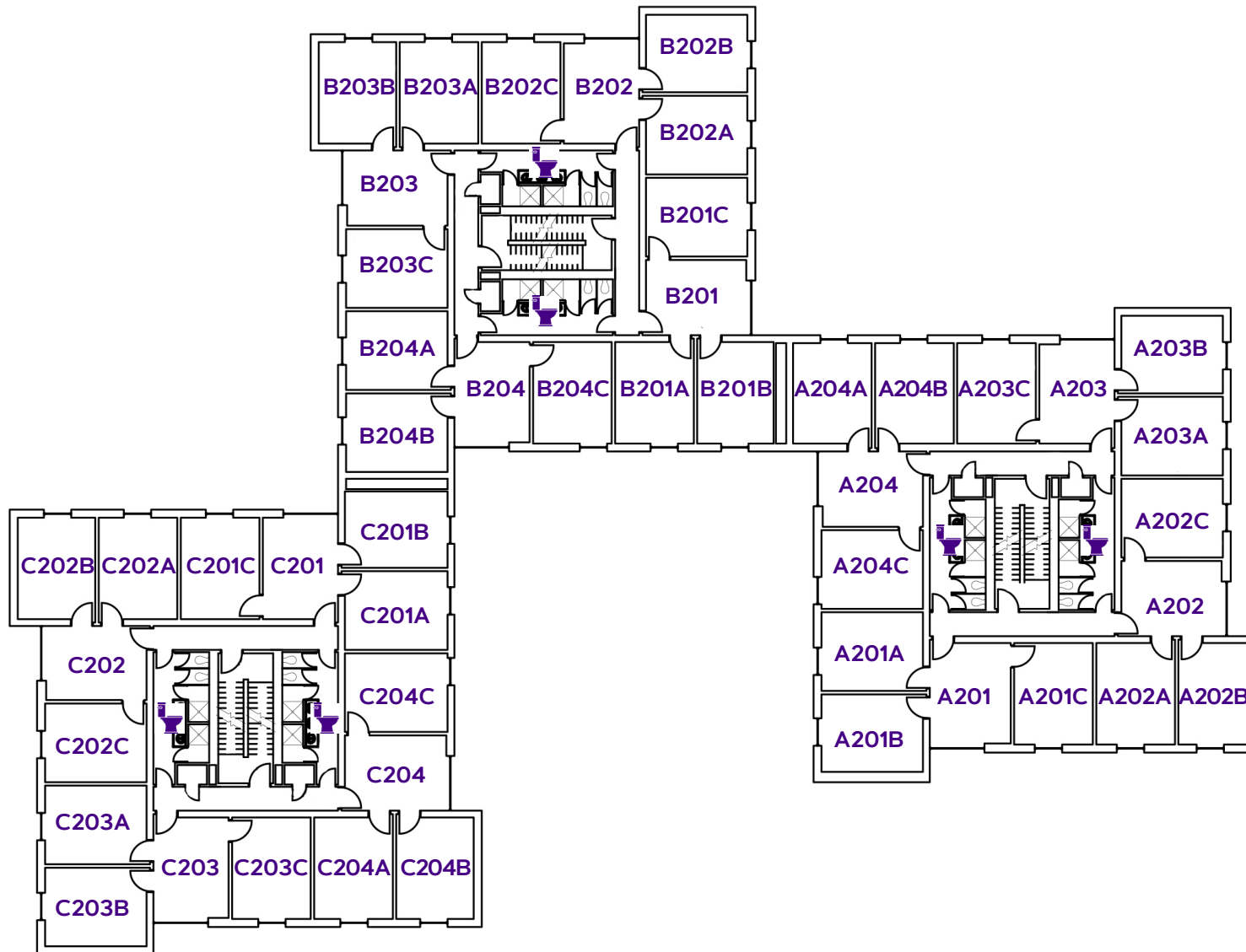

LEGEND:

- : Bathroom
- : Elevator
- : Mechanical Space/Misc. Use
- : Trash Room/Disposal Area
- : ADA Accessible Space
- : Hearing Equipment
- HD: Hall Director
- KTCH: Kitchen/Kitchenette
- LDRY: Laundry Room
- LNG: Lounge
Study Space/Room
Programming Space







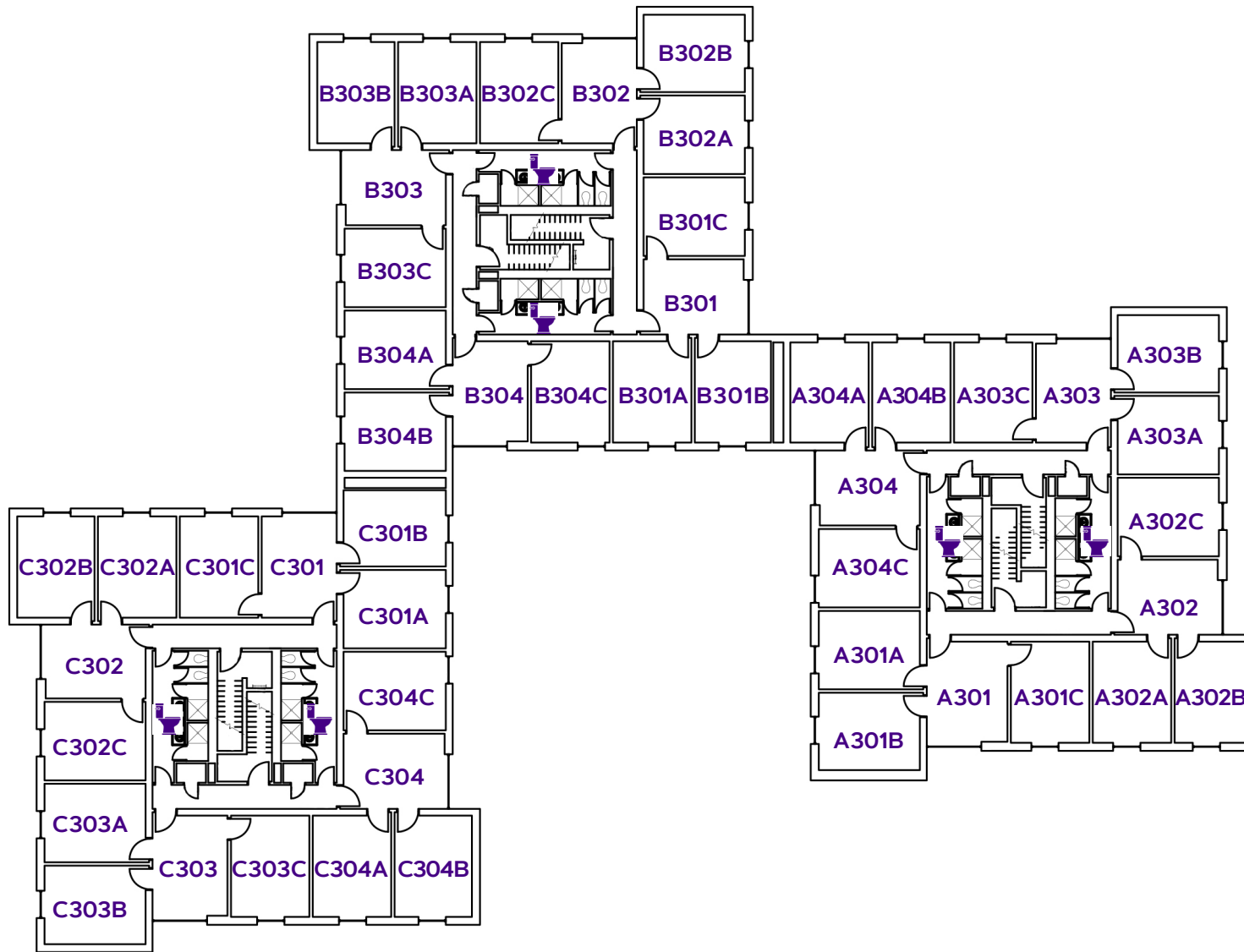

Residence Life

GARBER HALL

FLOOR THREE



LEGEND:

-  :Bathroom
-  :Elevator
-  :Mechanical Space/Misc. Use
-  :Trash Room/Disposal Area
-  :ADA Accessible Space
-  :Hearing Equipment
- HD:** Hall Director
- KTCH:** Kitchen/Kitchenette
- LDRY:** Laundry Room
- LNG:** Lounge
Study Space/Room
Programming Space



Residence Life

GARBER HALL

ACCESSIBLE DESCRIPTION OF FLOOR PLAN

COMPLETED: 1969

CAPACITY: 204 residents

This hall is constructed in 4 sections, A,B,C & a lounge around a small courtyard, with steps and brick sidewalks to each section. The lounge is on the right before you enter the courtyard and contains the TV/recreation lounge, Hall Office, Vending, a private glass study lounge, 2 public bathrooms and the Hall Director apartment. There is a stairwell, accessed by card reader, in the left corner of the lounge that leads to the basement. The basement contains a large study lounge, glass room study, laundry room, community kitchen, inside bike rack, storage rooms, laundry services, housekeeping break room and an exit to a back stairwell that leads you to the dumpster outside.

As you enter the courtyard, through a covered breezeway, C section is on the left hand side. As you enter the C section lobby, C100 suite is on the left hand side and C101 is on the right. These 2 suites have private bathrooms within the suite space. A suite is typically 3 double rooms that share a common room in the middle, that is behind a locked door. All other suites in the section, share a community bathroom, in-between 2 suites. To reach C102, there is a door with a card reader on the right, to access that suites hallway. C103 is the same, except on the left of the lobby. To reach suites 201-202, 303-304, there is a card access controlled door on the left side of the lobby, next to the door to C103. For suites 203-204, 301-302, that secure stairwell door is on the right, next to the C102 door. There is a community water fountain in the center of the lobby, between the stairwell doors.

Both Section B and A are identical to the description of C above. B section is straight ahead as you enter the courtyard, A is to the right. Each residential section, (A,B,C) are 3 stories.