

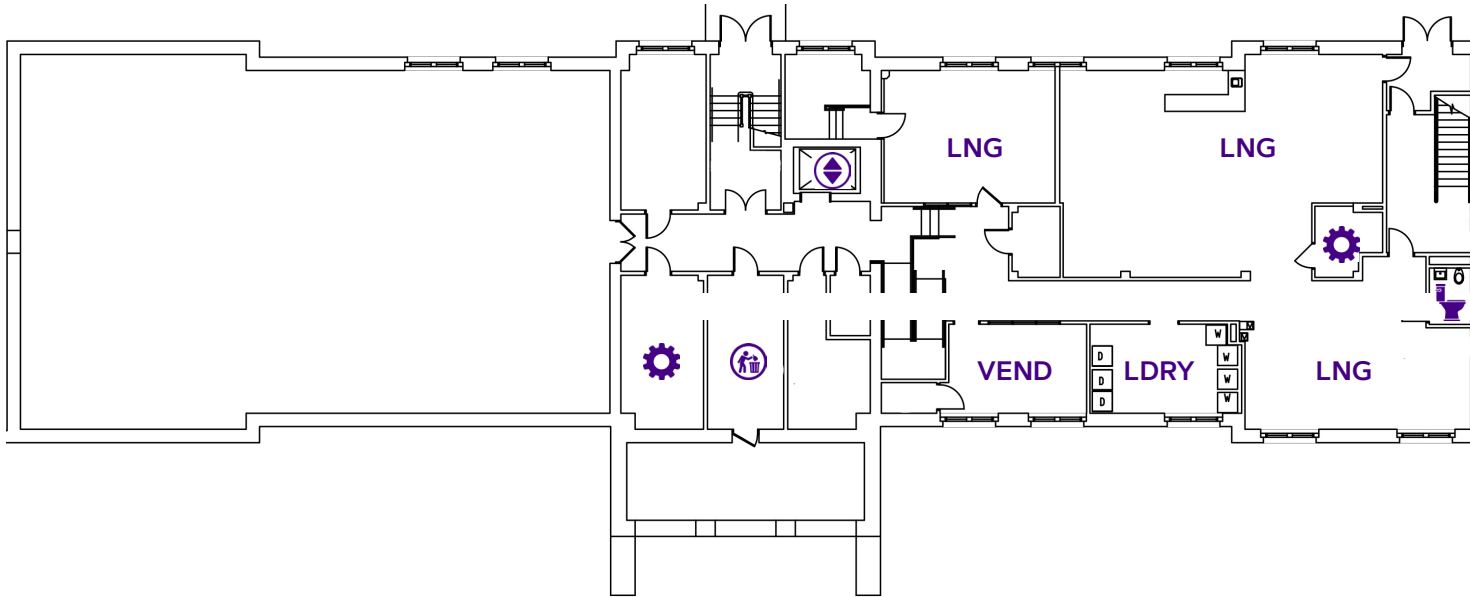





CONVERSE HALL

BASEMENT

BACK ENTRANCE
FACES HARRISON HALL/PARKING LOT



LEGEND:

-  : Bathroom
-  : Elevator
-  : Mechanical Space/Misc. Use
-  : Trash Room/Disposal Area
-  : ADA Accessible Space
-  : Hearing Equipment
- HD:** Hall Director
- KTCH:** Kitchen/Kitchenette
- LDRY:** Laundry Room
- LNG:** Lounge
Study Space/Room
Programming Space



Residence Life

CONVERSE HALL

FLOOR ONE

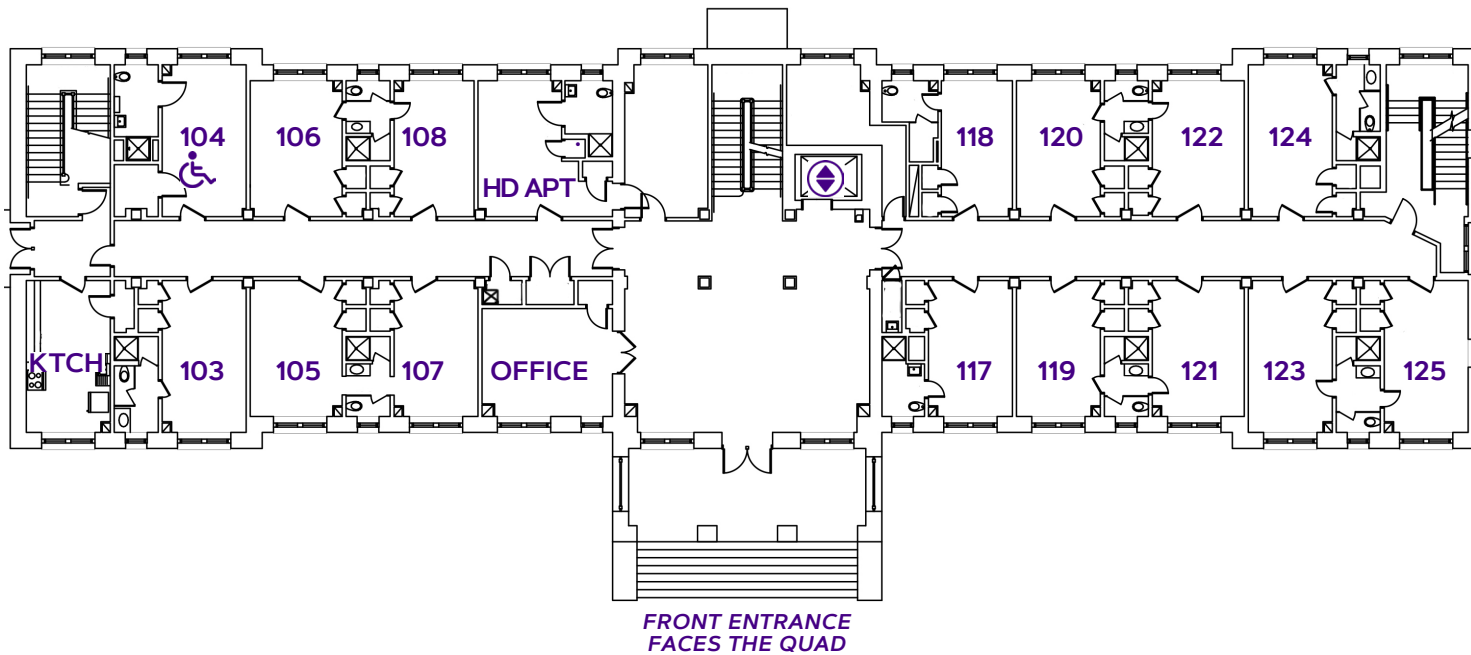

LEGEND:

- :Bathroom
- :Elevator
- :Mechanical Space/Misc. Use
- :Trash Room/Disposal Area
- :ADA Accessible Space
- :Hearing Equipment
- HD: Hall Director
- KTCH: Kitchen/Kitchenette
- LDRY: Laundry Room
- LNG: Lounge
Study Space/Room
Programming Space







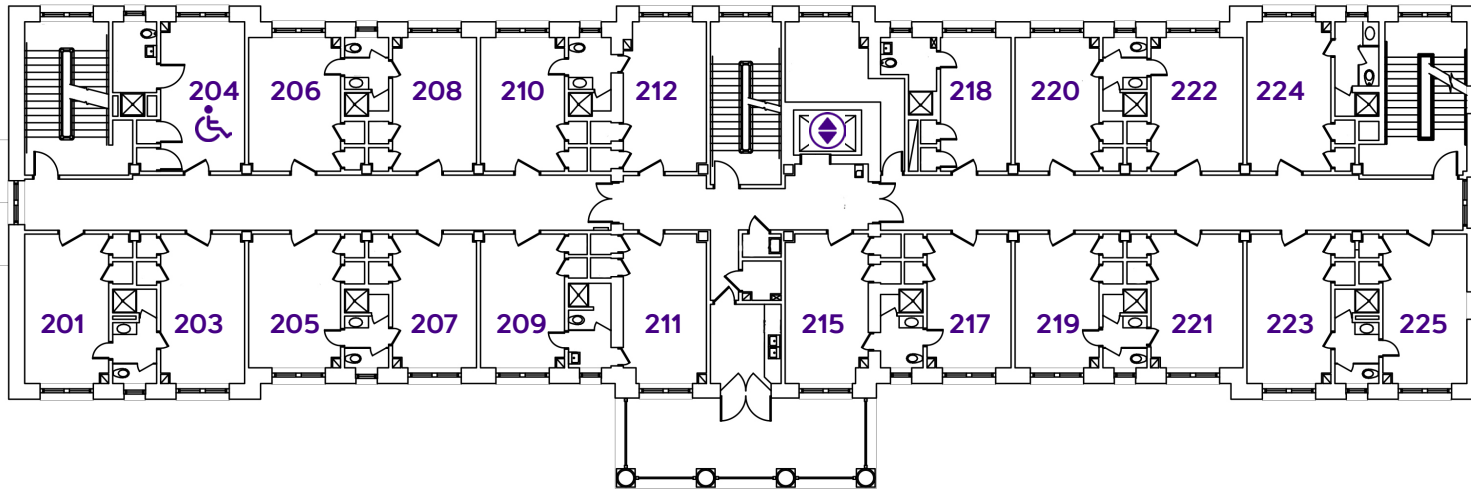

Residence Life

CONVERSE HALL

FLOOR TWO



LEGEND:





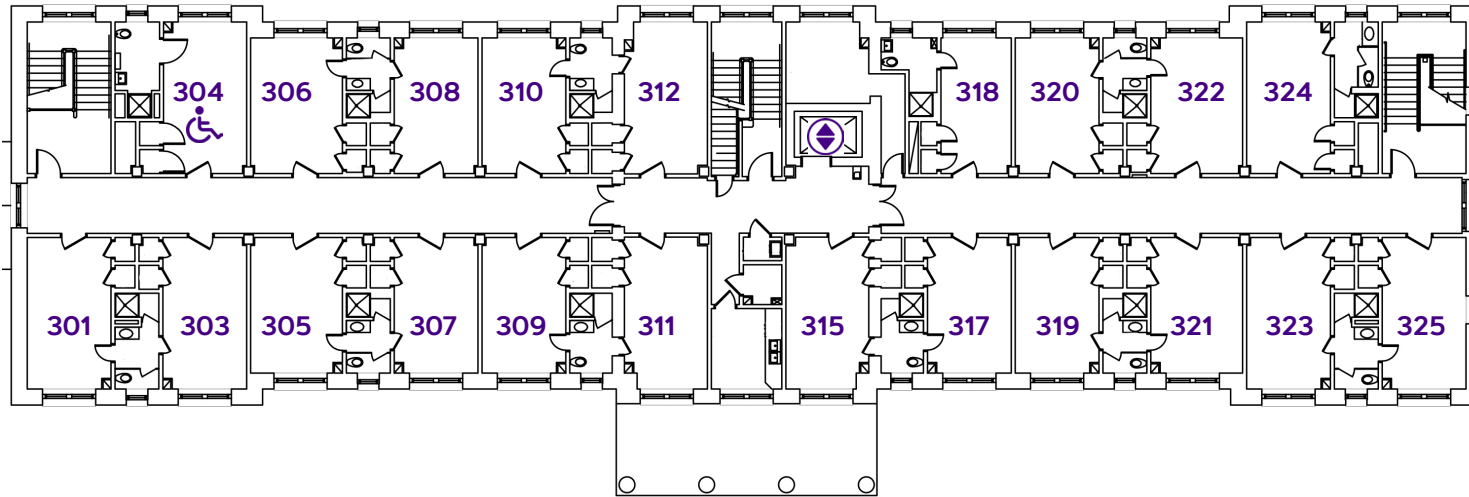

-  :Bathroom
-  :Elevator
-  :Mechanical Space/Misc. Use
-  :Trash Room/Disposal Area
-  :ADA Accessible Space
-  :Hearing Equipment
- HD:** Hall Director
- KTCH:** Kitchen/Kitchenette
- LDRY:** Laundry Room
- LNG:** Lounge
Study Space/Room
Programming Space

CONVERSE HALL

FLOOR THREE



LEGEND:

-  :Bathroom
-  :Elevator
-  :Mechanical Space/Misc. Use
-  :Trash Room/Disposal Area
-  :ADA Accessible Space
-  :Hearing Equipment
- HD:** Hall Director
- KTCH:** Kitchen/Kitchenette
- LDRY:** Laundry Room
- LNG:** Lounge
Study Space/Room
Programming Space



Residence Life

CONVERSE HALL

ACCESSIBLE DESCRIPTION OF FLOOR PLAN

COMPLETED: 1935, Renovated in 2001

CAPACITY: 108 residents

This building is a 3-story rectangular building with a basement. There are two entrances into the basement floor, both from the back side of the building facing the parking lot. The entrance in the middle leads straight into a stairwell where you must go down one, small flight of stairs to reach the basement and up to reach the first floor. The second entrance is in the left corner of the back side of the building. This door leads you into a vestibule with two doors. The door directly in front of you leads to a stairwell. The door directly to your right leads into a large recreational room. When you walk through this door, there is a counter and sink directly in front of you. If you turn to the left, there is a walkway leading you to a smaller lounge area. To your left is a public bathroom. To the left of the bathroom is a door leading into the stairwell. To the right is a corridor; down this corridor and on the left is the laundry and vending rooms. You turn right at the end of the corridor. In front of you is a closed, glass study room. To the left is first a ramp and then a small flight of stairs. If you use the ramp, turn left to face a new corridor. On the left is the trash room, housekeeping room, and mechanical space. On the right is the elevator, stairwell, and mechanical space.

The first floor has two entrances. The front entrance faces the road and has stairs. The side entrance faces Harper Allen Lee Hall. When you enter through this door, there is a kitchen on your right and a stairwell on your left. The rest of the hall is bedrooms. When you reach the end of the hall, you are in the lobby. On the left is a stairwell and an elevator. When you turn tight into the lobby, the hall office is on the left, and the main entrance is in front of you. If you go straight from the hallway, past the elevator, is another hallway of bedrooms. At the end of the hallway, on the left, is another stairwell. If you enter the building from the front entrance, the office will be on your left and the elevator and stairwell will be in front of you. The hallways of bedrooms will be on either side.

The second and third floors are all bedrooms with stairwells on both ends of the hallway and in the middle. The elevator is next to the middle stairwell and there is a kitchen across from the middle stairwell.