

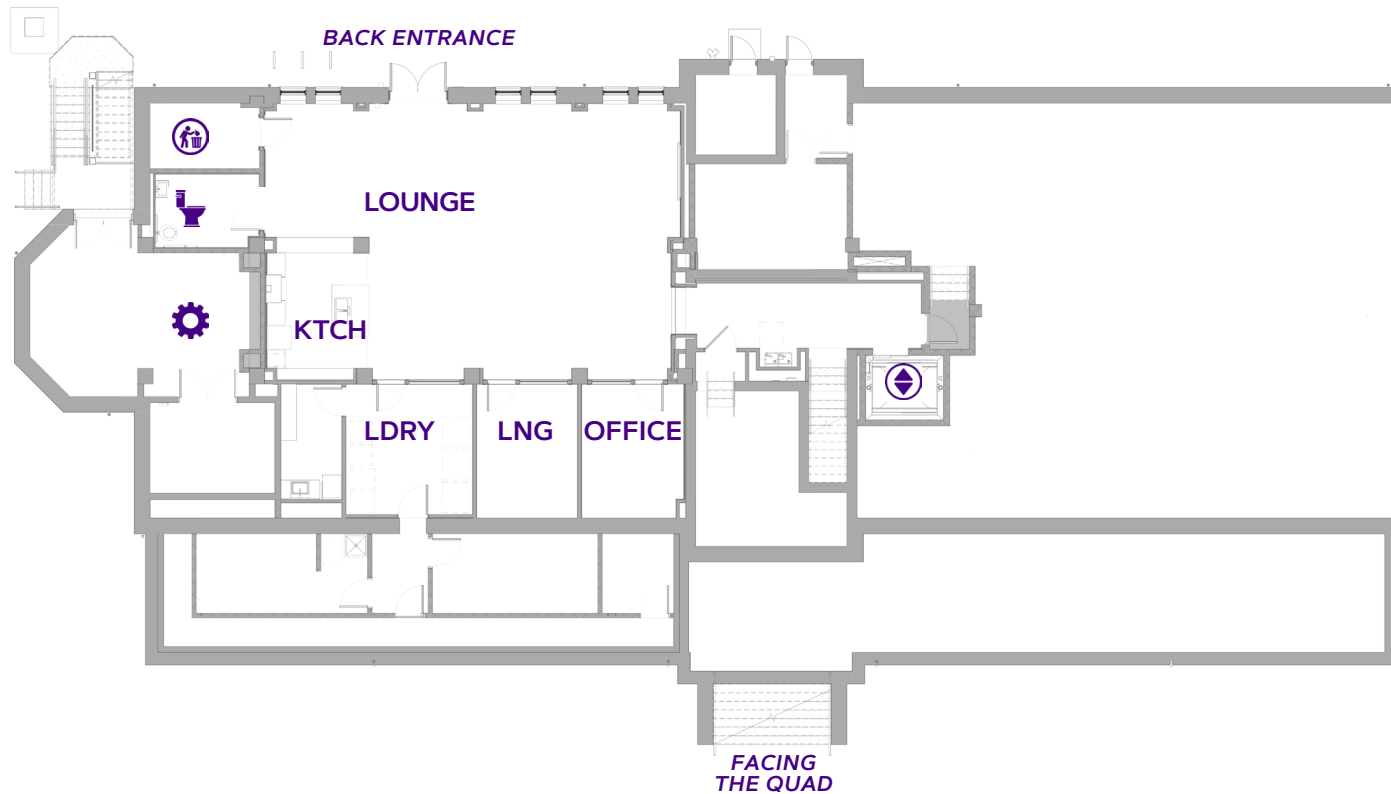





ALGER HALL

BASEMENT



LEGEND:





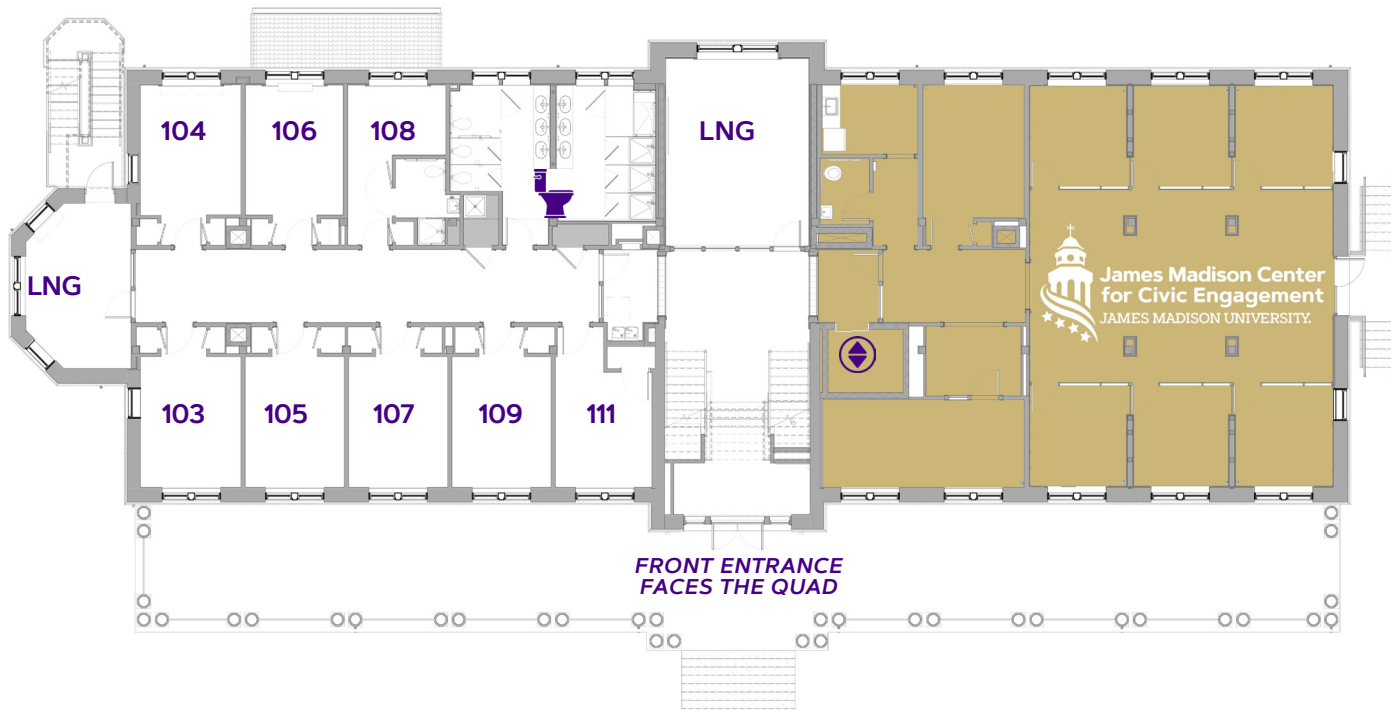

-  :Bathroom
-  :Elevator
-  :Mechanical Space/Misc. Use
-  :Trash Room/Disposal Area
-  :ADA Accessible Space
-  :Hearing Equipment
- HD:** Hall Director
- KTCH:** Kitchen/Kitchenette
- LDRY:** Laundry Room
- LNG:** Lounge
Study Space/Room
Programming Space

ALGER HALL

FLOOR ONE



LEGEND:





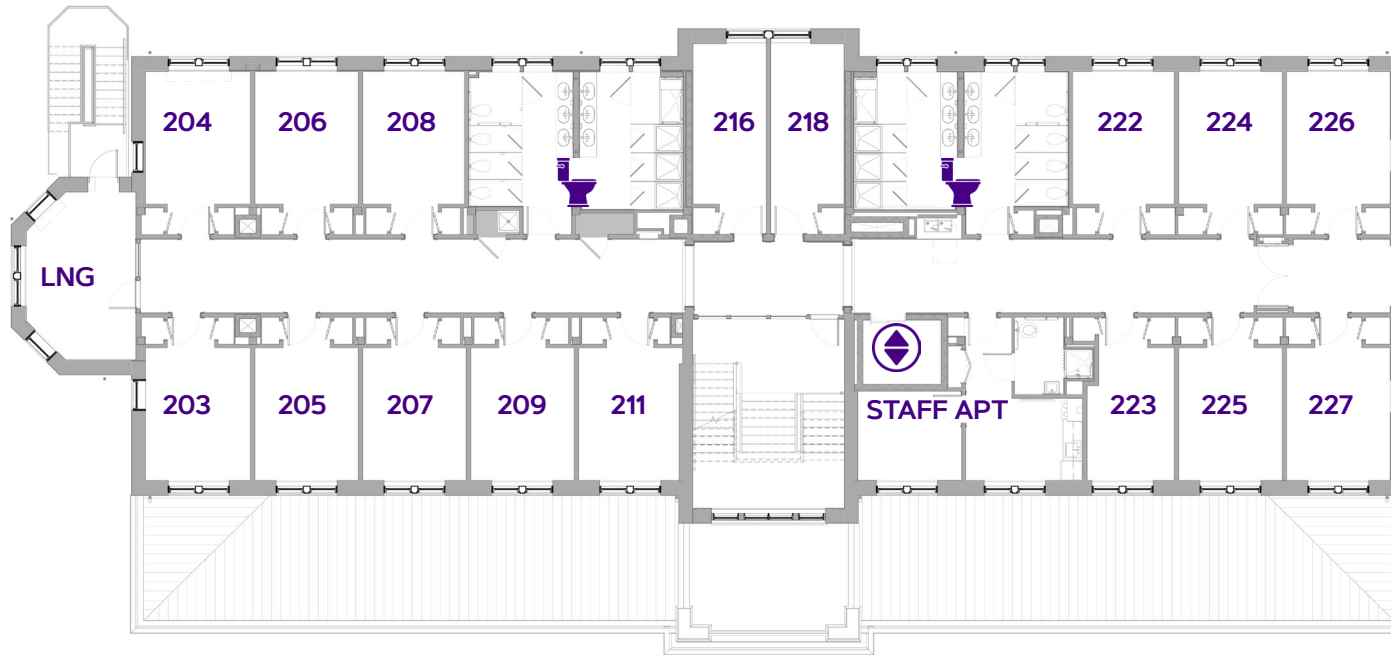

-  :Bathroom
-  :Elevator
-  :Mechanical Space/Misc. Use
-  :Trash Room/Disposal Area
-  :ADA Accessible Space
-  :Hearing Equipment
- HD:** Hall Director
- KTCH:** Kitchen/Kitchenette
- LDRY:** Laundry Room
- LNG:** Lounge
Study Space/Room
Programming Space

ALGER HALL

FLOOR TWO



LEGEND:

-  :Bathroom
-  :Elevator
-  :Mechanical Space/Misc. Use
-  :Trash Room/Disposal Area
-  :ADA Accessible Space
-  :Hearing Equipment
- HD:** Hall Director
- KTCH:** Kitchen/Kitchenette
- LDRY:** Laundry Room
- LNG:** Lounge
Study Space/Room
Programming Space

ALGER HALL

ACCESSIBLE DESCRIPTION OF FLOOR PLAN

COMPLETED: 2026; Formerly Spotswood Hall, built in 1917

CAPACITY: 44 residents

This building is a 2 story, rectangular, Bluestone building with a basement. On the right of the first floor is the Madison Center for Civic Engagement. Their offices can be accessed from the door on the right side of the building, facing Sheldon hall, or by entering the double door in the center of the first floor, (facing the quad,) and the entry will be on the right. Either entrance requires stairs. Accessible entry is on the backside of the building facing Cleveland hall, into the basement.

As you enter the basement, you are in a large TV lounge recreation space. On the left is the TV area and upholstered seating options. There is a pool table on the right and also a public bathroom and the trash/recycling room. Directly in front of you, is the community kitchen, with stove, fridge, sink and ice maker. Past the kitchen is an enclosed laundry and vending room. To the left of the laundry room is a glass study lounge room and to the left of that is the hall office. As you continue to your left you will find the landing for the elevator.

On the first floor, on the left, opposite the Madison Center, is a residential hallway accessed through a glass door with a card reader. Double rooms are on either side of the hall and there are 2 single rooms. These rooms share a community bathroom on the right, with enclosed shower partitions on one side, commodes on the other and shared sinks in the middle. There is also an end lounge on the far end of the hall that looks toward the Music building that has a fire escape door.

The 2nd floor is similar to the first, except it goes for the entire 2nd floor. There are 2 community bathrooms that serve mostly double rooms. There are 3 single rooms. Again there is a lounge on the left side of the building, facing the Music building that has a fire escape door. The 2nd floor also contains an apartment for the senior RA, to the right of the elevator.